

# TALL & PANTRY

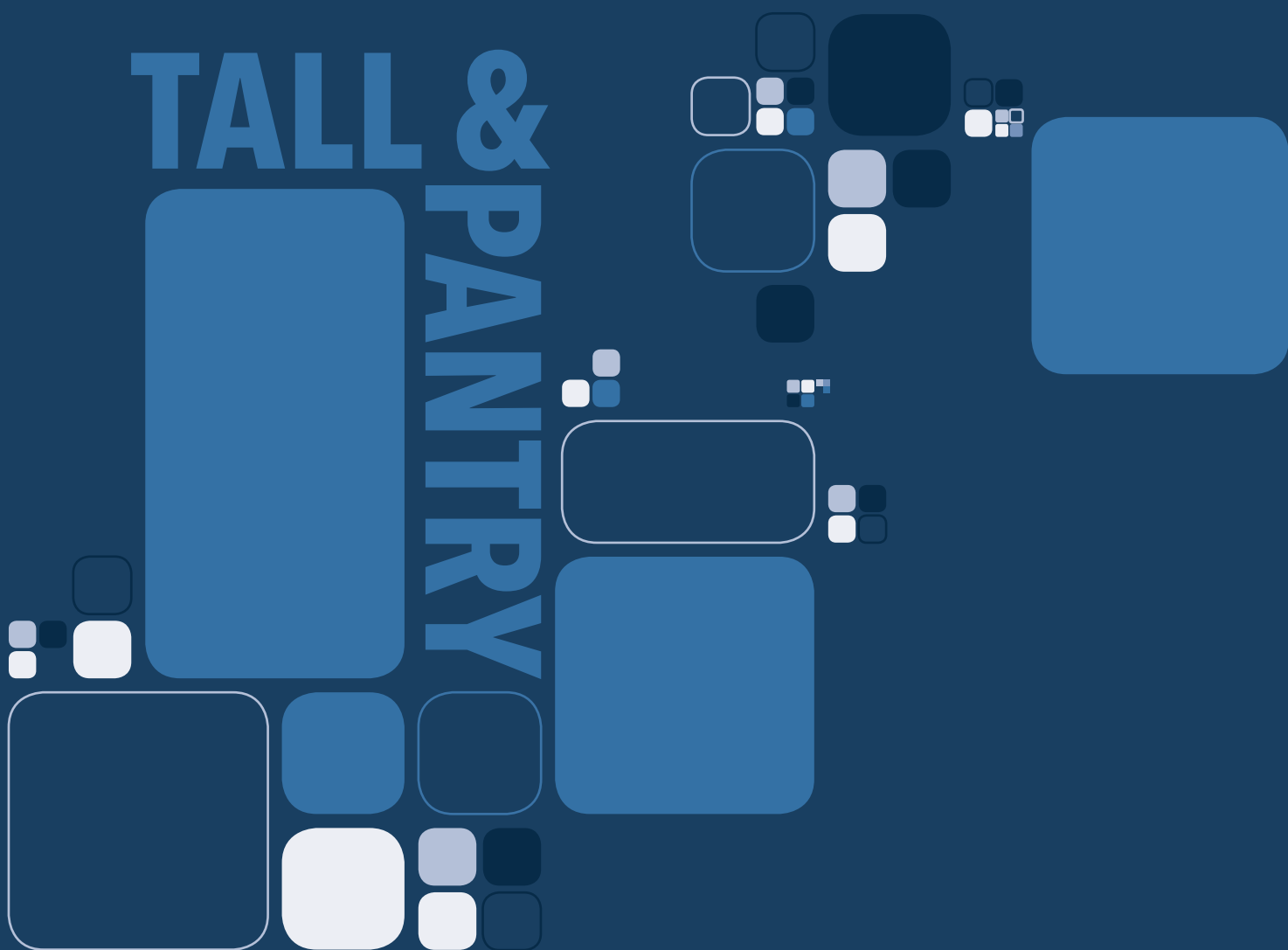



# TALL & PANTRY

Organizing your pantry is easier than ever with Rev-A-Shelf's innovative line of accessories. Whether you prefer the beautiful look of wood, the luxurious style of chrome, or the more practical polymer, you are sure to find the perfect answer to your walk-in or in-cabinet pantry needs. Designed to increase functionality and enhance the look and performance of your kitchen, our ground breaking accessories provide easy access and organization for everyday items.

## 4PIL SERIES

### PILASTER SYSTEM

- Designed for 18" and 24" base cabinets
- Double and triple drawer options available
- Tall drawers feature peg board bottoms, pegs and metal dividers
- BLUMOTION Soft-Close
- Stackable for use in a pantry applications
- Easily adjustable drawer height locations for storing tall and short items



For video visit:  
rev-a-shelf.com/videos

TALL AND PANTRY  
ACCESSORIES

COMING SUMMER 2016!

NEW!

Featuring  
**blum**  
Concealed runners and Soft-Close

4PIL-21-1 (2)  
4WDB4-PIL-24SC-1 (3)  
4WDB7-PIL-24SC-1 (2)

| PRODUCT #                              | DESCRIPTION   | DIMENSIONS   | FINISH | SET PER CTN | WHT PER CARTON | SUGGESTED LIST PRICE |
|--|---|--|--------|-------------|----------------|----------------------|
| Kits with slides and pilaster uprights |   |  |        |             |                |                      |
| 4PIL-18SC-2                            | (1) Standard, (1) Tall with dividers for 18 in. door drawer cabinet | 16 $\frac{5}{8}$ " (567 mm) W* x 21 $\frac{5}{8}$ " (549 mm) D x 21 $\frac{1}{4}$ " (540 mm) H | Wood   | 1           | 32 lb.         | \$562.30             |
| 4PIL-18SC-3                            | (2) Standard, (1) Tall with dividers for 18 in. full height cabinet | 16 $\frac{5}{8}$ " (567 mm) W* x 21 $\frac{5}{8}$ " (549 mm) D x 22 $\frac{3}{4}$ " (578 mm) H | Wood   | 1           | 46 lb.         | \$760.95             |
| 4PIL-24SC-2                            | (1) Standard, (1) Tall with dividers for 24 in. door drawer cabinet | 22 $\frac{5}{8}$ " (567 mm) W* x 21 $\frac{5}{8}$ " (549 mm) D x 21 $\frac{1}{4}$ " (540 mm) H | Wood   | 1           | 40 lb.         | \$626.85             |
| 4PIL-24SC-3                            | (2) Standard, (1) Tall with dividers for 24 in. full height cabinet | 22 $\frac{5}{8}$ " (567 mm) W* x 21 $\frac{5}{8}$ " (549 mm) D x 23 $\frac{3}{4}$ " (603 mm) H | Wood   | 1           | 56 lb.         | \$847.65             |
| Individual parts                       |   |  |        |             |                |                      |
| 4WDB4-PIL-18SC-1                       | (1) Standard drawer for 18 in. cabinet with Blum slides             | 13 $\frac{3}{8}$ " (340 mm) W x 21" (533 mm) D x 4" (102 mm) H (drawers only)                  | Wood   | 1           | 16.5 lb.       | \$240.00             |
| 4WDB7-PIL-18SC-1                       | (1) Tall drawer with dividers for 18 in. cabinet with Blum slides   | 13 $\frac{3}{8}$ " (340 mm) W x 21" (533 mm) D x 7" (178 mm) H (drawers only)                  | Wood   | 1           | 18.5 lb.       | \$313.80             |
| 4WDB4-PIL-24SC-1                       | (1) Standard drawer for 24 in. cabinet with Blum slides             | 19 $\frac{3}{8}$ " (492 mm) W x 21" (533 mm) D x 4" (102 mm) H (drawers only)                  | Wood   | 1           | 20 lb.         | \$264.75             |
| 4WDB7-PIL-24SC-1                       | (1) Tall drawer with dividers for 24 in. cabinet with Blum slides   | 19 $\frac{3}{8}$ " (567 mm) W x 21" (533 mm) D x 7" (178 mm) H (drawers only)                  | Wood   | 1           | 24 lb.         | \$354.25             |
| 4PIL-21-1                              | Pilaster Upright Kit  | 1" (25 mm) W† x 1" (25 mm) D x 21" (533 mm) H  |        | 1           | 6 lb.          | \$77.30              |
| 4PIL-21-10                             | Bulk Pack Pilaster Upright Kit                                      |  |        | 10          | 41 lb.         | \$46.40              |
| 4PIL-BUTTON-1                          | Pilaster upright button kit for slide attach (1 set of 4 buttons)   |  |        | 1           | 1 lb.          | \$5.65               |
| 4PIL-BUTTON-12                         | Pilaster upright buttons for slide attach (12 sets of 4 buttons)    |  |        | 12          | 5 lb.          | \$2.20               |

**NOTES:** To see Pilaster system in a base cabinet application turn to page 96.

**NOTE:** \*Adjustable +/- 3/8" in. †Adjustable to 1-3/8" in.

SHORT DRAWER ON TOP  
MAX HEIGHT

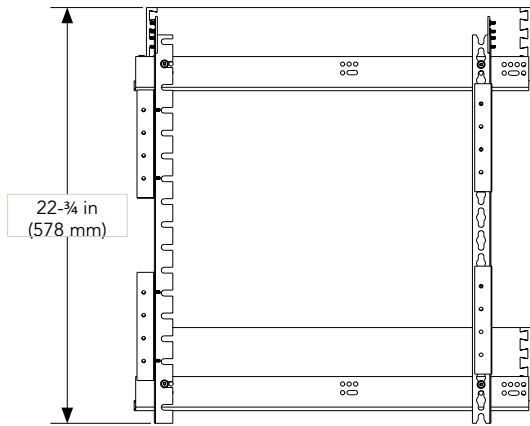

TALL DRAWER ON TOP  
MAX HEIGHT

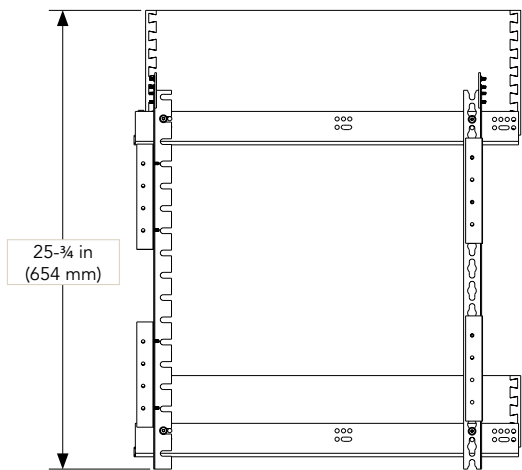

STACKED PILASTER SYSTEM  
TALL DRAWER ON TOP  
MAX HEIGHT

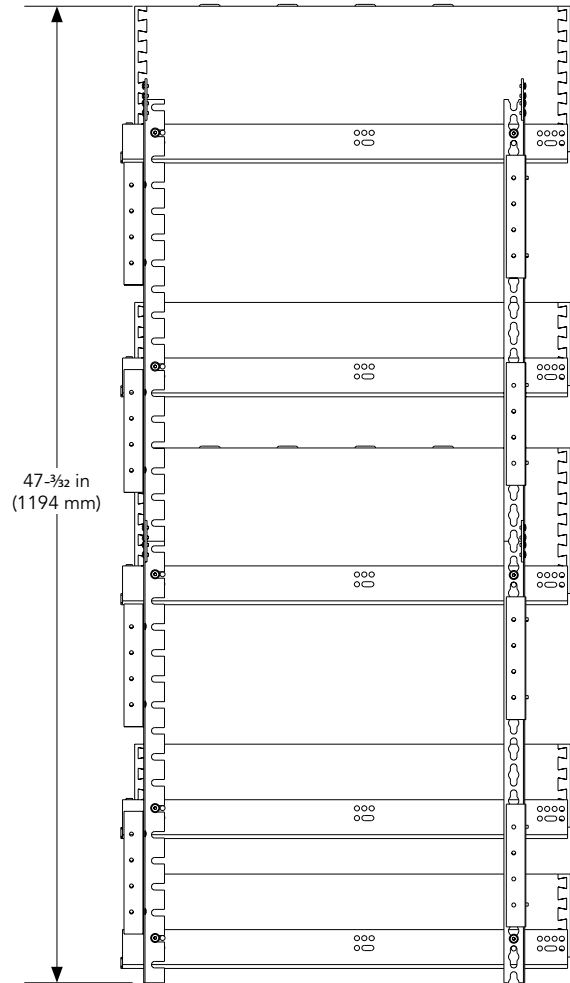

SOLID DOVETAIL CONSTRUCTION



BLUMOTION SOFT-CLOSE SLIDES



BASE CABINET APPLICATION





## 448-TP SERIES

### PULLOUT WOOD PANTRY

#### Pantry Features:

- Shipped ready to assemble
- Kit packaged with slide
- All mounting hardware included
- Patented Door Mount Brackets with micro-adjustment and 5" of adjustability
- System hole shelf adjustment
- Fully accessible top shelf
- Rub bushings included for 1-1/2", 1-5/8", 1-3/4" face frames
- CARB II Compliant

#### Slide Features:

- 450 lb. rated static  
250 lb. recommended use with pantry
- Heavy-duty gas assisted Soft-Close
- Innovative tilt adjustment
- Adjustment screws to center pantry
- Adjustment tool and consumer tip sheet included
- Pull-force is equal to opening a high-end refrigerator



#### VERTICAL ADJUSTMENT



#### HORIZONTAL ADJUSTMENT



#### ASTOUNDING STORAGE CAPACITY!



#### Adjustable Mounting Brackets US PATENT: 8,388,076



#### ADJUSTABLE SHELVES!



## 448-TP SERIES PULLOUT WOOD PANTRY FRAMELESS "EURO" CABINET APPLICATION

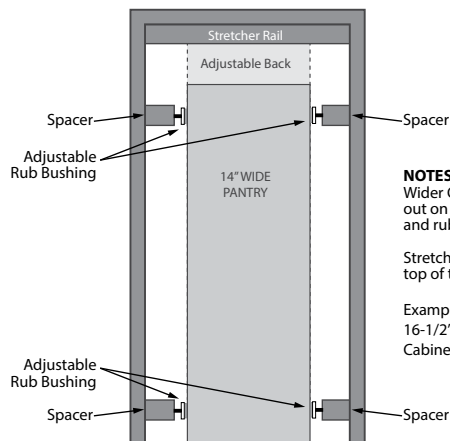

**NOTES:**  
Wider Cabinet openings must be blocked out on both sides of the pantry and rub bushings must be used.

Stretcher Rail must be installed at the top of the cabinet opening.

Example:  
16-1/2" Wide  
Cabinet Opening

## 448-TP SERIES PULLOUT WOOD PANTRY MINIMUM/MAXIMUM WIDTH

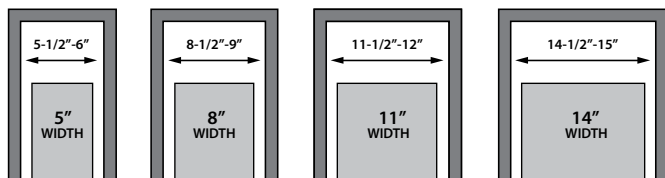

INSET RUB BUSHING!

SOLD SEPARATELY

For Inset applications or for those who prefer to keep their cabinets flawless we recommend our IDR bushing. The discreet design prevents side to side movement and fits behind the frame eliminating the need for surface drilling giving you a seamless look and unparalleled stability.



ADJUSTABLE RUB BUSHING!

| PRODUCT DIMENSIONS |              |              |  |  | CABINET DIMENSIONS                                  |   |
|--------------------|--------------|--------------|--|--|---|---|
| PART #             | WIDTH        | DEPTH        | HEIGHT (MIN)                               | HEIGHT (MAX)                               | WIDTH (MIN/MAX)                                     | HEIGHT (MIN/MAX)                                      |
| 448-TP43-5-1       | 5" (127 mm)  | 22" (559 mm) | 43 <sup>3</sup> / <sub>8</sub> " (1102 mm) | 51 <sup>7</sup> / <sub>8</sub> " (1318 mm) | 5 <sup>1</sup> / <sub>2</sub> " - 6" (140-153 mm)   | 43 <sup>1</sup> / <sub>2</sub> " - 51" (1105-1296 mm) |
| 448-TP51-5-1       | 5" (127 mm)  | 22" (559 mm) | 50 <sup>7</sup> / <sub>8</sub> " (1293 mm) | 59 <sup>3</sup> / <sub>8</sub> " (1509 mm) | 5 <sup>1</sup> / <sub>2</sub> " - 6" (140-153 mm)   | 51" - 58 <sup>1</sup> / <sub>2</sub> " (1296-1486 mm) |
| 448-TP58-5-1       | 5" (127 mm)  | 22" (559 mm) | 58 <sup>3</sup> / <sub>8</sub> " (1483 mm) | 66 <sup>7</sup> / <sub>8</sub> " (1699 mm) | 5 <sup>1</sup> / <sub>2</sub> " - 6" (140-153 mm)   | 58 <sup>1</sup> / <sub>2</sub> " - 66" (1486-1677 mm) |
| 448-TP43-8-1       | 8" (204 mm)  | 22" (559 mm) | 43 <sup>1</sup> / <sub>4</sub> " (1099 mm) | 51 <sup>1</sup> / <sub>8</sub> " (1316 mm) | 8 <sup>1</sup> / <sub>2</sub> " - 9" (216-229 mm)   | 43 <sup>1</sup> / <sub>2</sub> " - 51" (1105-1296 mm) |
| 448-TP51-8-1       | 8" (204 mm)  | 22" (559 mm) | 50 <sup>3</sup> / <sub>4</sub> " (1289 mm) | 59 <sup>5</sup> / <sub>8</sub> " (1507 mm) | 8 <sup>1</sup> / <sub>2</sub> " - 9" (216-229 mm)   | 51" - 58 <sup>1</sup> / <sub>2</sub> " (1296-1486 mm) |
| 448-TP58-8-1       | 8" (204 mm)  | 22" (559 mm) | 58 <sup>1</sup> / <sub>4</sub> " (1480 mm) | 66 <sup>1</sup> / <sub>8</sub> " (1697 mm) | 8 <sup>1</sup> / <sub>2</sub> " - 9" (216-229 mm)   | 58 <sup>1</sup> / <sub>2</sub> " - 66" (1486-1677 mm) |
| 448-TP43-11-1      | 11" (280 mm) | 22" (559 mm) | 43 <sup>1</sup> / <sub>4</sub> " (1099 mm) | 51 <sup>1</sup> / <sub>8</sub> " (1316 mm) | 11 <sup>1</sup> / <sub>2</sub> " - 12" (292-305 mm) | 43 <sup>1</sup> / <sub>2</sub> " - 51" (1105-1296 mm) |
| 448-TP51-11-1      | 11" (280 mm) | 22" (559 mm) | 50 <sup>3</sup> / <sub>4</sub> " (1289 mm) | 59 <sup>5</sup> / <sub>8</sub> " (1507 mm) | 11 <sup>1</sup> / <sub>2</sub> " - 12" (292-305 mm) | 51" - 58 <sup>1</sup> / <sub>2</sub> " (1296-1486 mm) |
| 448-TP58-11-1      | 11" (280 mm) | 22" (559 mm) | 58 <sup>1</sup> / <sub>4</sub> " (1480 mm) | 66 <sup>1</sup> / <sub>8</sub> " (1697 mm) | 11 <sup>1</sup> / <sub>2</sub> " - 12" (292-305 mm) | 58 <sup>1</sup> / <sub>2</sub> " - 66" (1486-1677 mm) |
| 448-TP43-14-1      | 14" (356 mm) | 22" (559 mm) | 43 <sup>1</sup> / <sub>4</sub> " (1099 mm) | 51 <sup>1</sup> / <sub>8</sub> " (1316 mm) | 14 <sup>1</sup> / <sub>2</sub> " - 15" (369-381 mm) | 43 <sup>1</sup> / <sub>2</sub> " - 51" (1105-1296 mm) |
| 448-TP51-14-1      | 14" (356 mm) | 22" (559 mm) | 50 <sup>3</sup> / <sub>4</sub> " (1289 mm) | 59 <sup>5</sup> / <sub>8</sub> " (1507 mm) | 14 <sup>1</sup> / <sub>2</sub> " - 15" (369-381 mm) | 51" - 58 <sup>1</sup> / <sub>2</sub> " (1296-1486 mm) |
| 448-TP58-14-1      | 14" (356 mm) | 22" (559 mm) | 58 <sup>1</sup> / <sub>4</sub> " (1480 mm) | 66 <sup>1</sup> / <sub>8</sub> " (1697 mm) | 14 <sup>1</sup> / <sub>2</sub> " - 15" (369-381 mm) | 58 <sup>1</sup> / <sub>2</sub> " - 66" (1486-1677 mm) |

| PRODUCT #                             | DESCRIPTION                                   | FINISH | SET PER CTN | WHT PER CARTON | SUGGESTED LIST PRICE |
|---------------------------------------|---|--------|-------------|----------------|----------------------|
| Pullout Wood Pantry (Individual Pack) |   |        |             |                |                      |
| 448-TP43-5-1                          | 5" W x 43" H Wood Pantry with Slide           | Wood   | 1           | 54 lb.         | \$583.65             |
| 448-TP51-5-1                          | 5" W x 51" H Wood Pantry with Slide           | Wood   | 1           | 57 lb.         | \$616.40             |
| 448-TP58-5-1                          | 5" W x 58" H Wood Pantry with Slide           | Wood   | 1           | 60 lb.         | \$644.55             |
| 448-TP43-8-1                          | 8" W x 43" H Wood Pantry with Slide           | Wood   | 1           | 62 lb.         | \$616.25             |
| 448-TP51-8-1                          | 8" W x 51" H Wood Pantry with Slide           | Wood   | 1           | 65 lb.         | \$660.35             |
| 448-TP58-8-1                          | 8" W x 58" H Wood Pantry with Slide           | Wood   | 1           | 68 lb.         | \$705.15             |
| 448-TP43-11-1                         | 11" W x 43" H Wood Pantry with Slide          | Wood   | 1           | 70 lb.         | \$679.90             |
| 448-TP51-11-1                         | 11" W x 51" H Wood Pantry with Slide          | Wood   | 1           | 75 lb.         | \$734.70             |
| 448-TP58-11-1                         | 11" W x 58" H Wood Pantry with Slide          | Wood   | 1           | 79 lb.         | \$788.80             |
| 448-TP43-14-1                         | 14" W x 43" H Wood Pantry with Slide          | Wood   | 1           | 78 lb.         | \$744.30             |
| 448-TP51-14-1                         | 14" W x 51" H Wood Pantry with Slide          | Wood   | 1           | 85 lb.         | \$809.45             |
| 448-TP58-14-1                         | 14" W x 58" H Wood Pantry with Slide          | Wood   | 1           | 89 lb.         | \$874.95             |
| IDRB-1                                | Adjustable Rub Bushing for Inset Applications | Metal  | 1           | 1 lb.          | \$12.65              |



**NOTE:** Pull-force is equal to opening a high-end refrigerator or dishwasher. Decorative Hardware Cabinet Pull should be mounted/positioned centrally on the cabinet door to allow 448-TP Wood Pantry to pull-out easily.



## 432 SERIES

### TALL FILLER ORGANIZERS

- Available for 6" applications, this filler comes in 39" and 45" heights
- Can be used alone or in conjunction with others to reach 84", 90", or 96" heights.
- Adjustable shelves:
  - 5 for the 39" model
  - 6 for the 45" model
- 150 lb. full-extension ball-bearing slides
- Features three-slide design that provides for the most stable function on the market



432-TF45-6C



EACH SECTION OF FILLER  
OPERATE INDEPENDENTLY!



INCLUDED MENDING PLATES  
SECURELY FASTENS THE  
FRAMES OF 2 FILLERS.

| PRODUCT #                                | DESCRIPTION               | PRODUCT DIMENSIONS                                | FINISH | SET PER CTN | WHT PER CARTON | SUGGESTED LIST PRICE |
|--|---------------------------|---|--------|-------------|----------------|----------------------|
| Tall Filler Organizers (Individual Pack) |                           |   |        |             |                |                      |
| 432-TF39-6C                              | 39" Tall Filler Organizer | 6" (153 mm) W x 23" (584 mm) D x 38½" (978 mm) H  | Wood   | 1           | 42 lb.         | \$ 373.50            |
| 432-TF45-6C                              | 45" Tall Filler Organizer | 6" (153 mm) W x 23" (584 mm) D x 44½" (1130 mm) H | Wood   | 1           | 46 lb.         | \$ 402.50            |

## 434 SERIES

### TALL STAINLESS FILLER ORGANIZERS

- Available for 6" applications, this filler comes in 39" and 45" heights
- Can be used alone or in conjunction with others to reach 84", 90", or 96" heights
- Features magnetic grade stainless steel panel and chrome accents
- Includes a variety of accessory hooks
- 150 lb. full-extension ball-bearing slides
- Features three-slide design that provides for the most stable function on the market

TALL AND PANTRY ACCESSORIES



434-TF39-6SS

432-TF45-6C

Can be combined with the 432 Series Tall Filler Organizers to create even more combinations!

Different combinations permit use in 30", 36" and 42" Wall Applications.

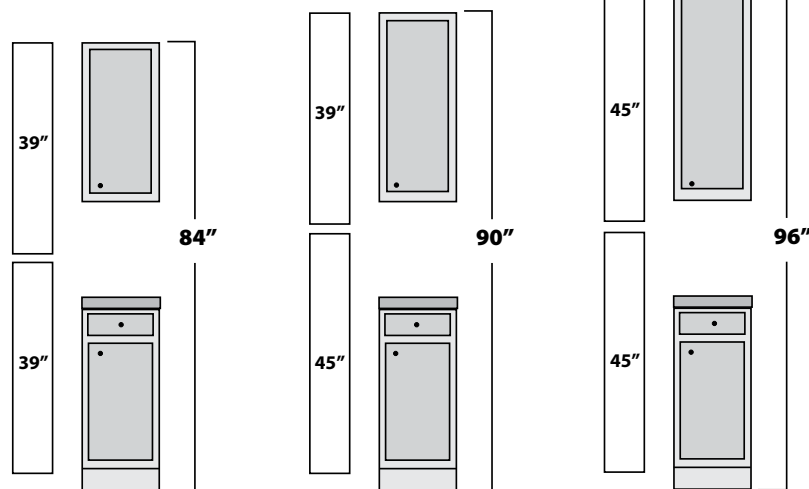

| PRODUCT #                                | DESCRIPTION                              | PRODUCT DIMENSIONS                                | FINISH | SET PER CTN | WHT PER CARTON | SUGGESTED LIST PRICE |
|--|--|---|--------|-------------|----------------|----------------------|
| Tall Filler Organizers (Individual Pack) |  |   |        |             |                |                      |
| 434-TF39-6SS                             | 39" Tall Filler Organizer (Left Handed)  | 6" (153 mm) W x 23" (584 mm) D x 38½" (978 mm) H  | Wood   | 1           | 33 lb.         | \$ 555.50            |
| 434-TF39R-6SS                            | 39" Tall Filler Organizer (Right Handed) | 6" (153 mm) W x 23" (584 mm) D x 38½" (978 mm) H  | Wood   | 1           | 33 lb.         | \$ 555.50            |
| 434-TF45-6SS                             | 45" Tall Filler Organizer (Left Handed)  | 6" (153 mm) W x 23" (584 mm) D x 44½" (1130 mm) H | Wood   | 1           | 47 lb.         | \$ 589.70            |
| 434-TF45R-6SS                            | 45" Tall Filler Organizer (Right Handed) | 6" (153 mm) W x 23" (584 mm) D x 44½" (1130 mm) H | Wood   | 1           | 47 lb.         | \$ 589.70            |



## 4W SERIES

### WOOD SWING-OUT PANTRY

- Designed for 36" full height base cabinets
- Features adjustable interior door and pantry shelves
- Includes removable chrome bars
- Solid construction consists of maple shelving with a UV-cured, clear finish swings out on an industrial piano hinge
- Complete kit includes two swing-out units and two door storage units with patented door mount brackets.

See page 93 for Base Cabinet version



Adjustable Mounting Brackets  
US PATENT: 7,204,569



Chrome Top Rails can be  
installed to store items!

MINIMUM  
CABINET HEIGHT  
4WBP18-25-KIT  
**25 $\frac{3}{4}$ " (654 mm)**  
without top rails

**28 $\frac{3}{4}$ " (730 mm)**  
with top rails



NOTE: CENTER WOOD PIECE NOT INCLUDED



Adjustable Shelves

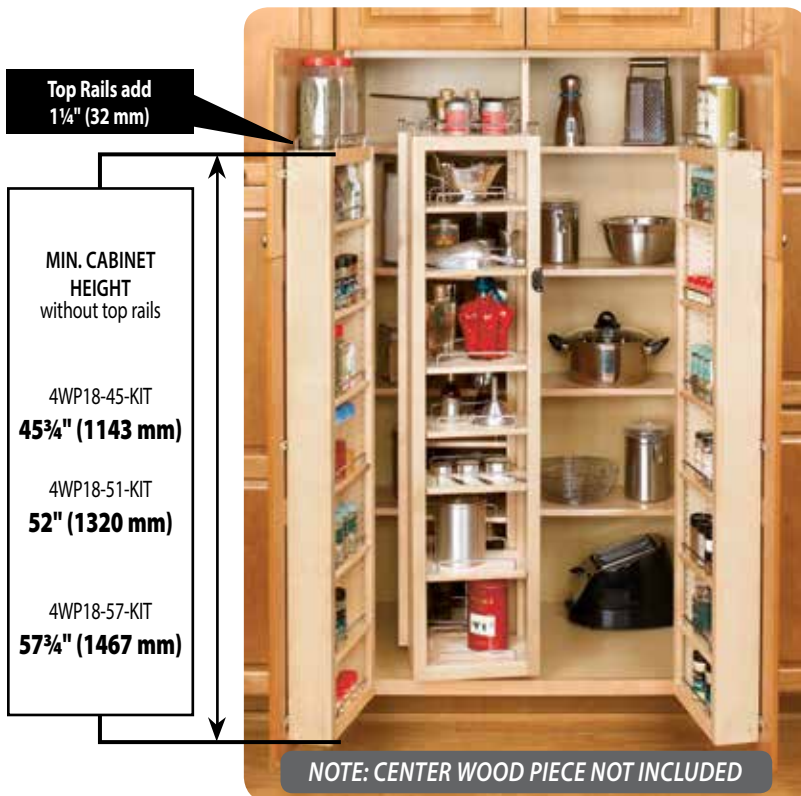
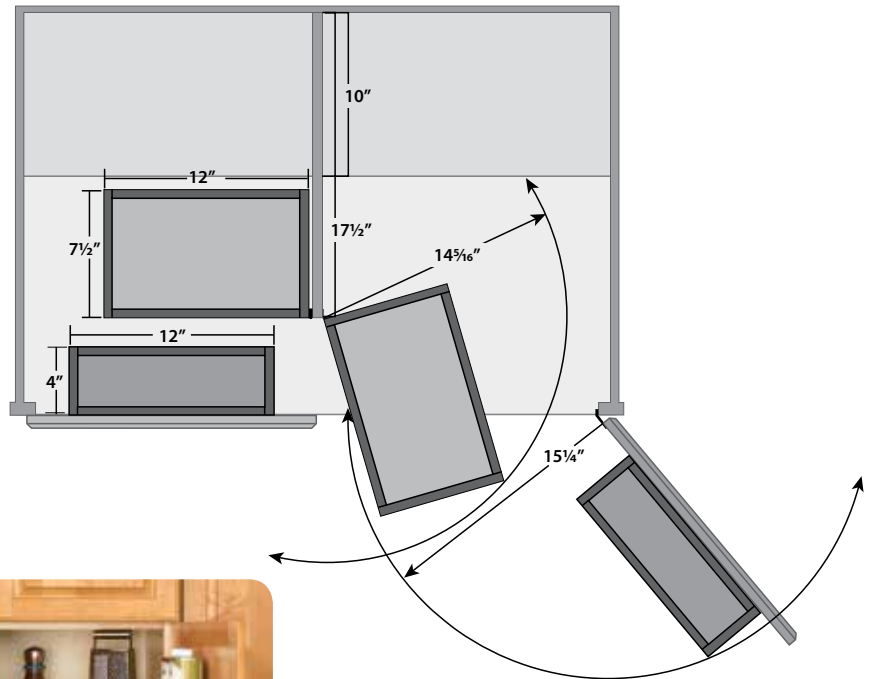

Top Rails add  
1 1/4" (32 mm)

MIN. CABINET  
HEIGHT  
without top rails

4WP18-45-KIT  
**45 3/4" (1143 mm)**

4WP18-51-KIT  
**52" (1320 mm)**

4WP18-57-KIT  
**57 3/4" (1467 mm)**

NOTE: CENTER WOOD PIECE NOT INCLUDED

| PRODUCT #  | DESCRIPTION   | PRODUCT DIMENSIONS                                       | FINISH | SET PER CTN | WHT PER CARTON | SUGGESTED LIST PRICE |
|--|---|--|--------|-------------|----------------|----------------------|
| Wood Swing Out Kits and Components (Individual Pack) |   |  |        |             |                |                      |
| 4WBSP18-25   | 25" Swing Out Pantry (w/Hardware) Single                              | 12" (305 mm) W x 7 1/2" (191 mm) D x 25" (635 mm) H      | Wood   | 1           | 17 lb.         | \$ 117.60            |
| 4WBDP18-25   | 25" Pantry Door Unit (w/Hardware) Single                              | 12" (305 mm) W x 4" (102 mm) D x 25" (1296 mm) H         | Wood   | 1           | 11 lb.         | \$103.80             |
| 4WBP18-25-KIT  | 25" Swing Out Pantry Kit - Includes (2) 4WBSP18-25 and (2) 4WBDP18-25 |  | Wood   | 1           | 60 lb.         | \$419.50             |
| 4WSP18-45  | 45" Swing Out Pantry (w/Hardware) Single                              | 12" (305 mm) W x 7 1/2" (191 mm) D x 45" (1143 mm) H     | Wood   | 1           | 18 lb.         | \$200.95             |
| 4WDP18-45  | 45" Pantry Door Unit (w/Hardware) Single                              | 12" (305 mm) W x 4" (102 mm) D x 45" (1143 mm) H         | Wood   | 1           | 18 lb.         | \$156.45             |
| 4WP18-45-KIT   | 45" Swing Out Pantry Kit - Includes (2) 4WDP18-45 and (2) 4WSP18-45   |  | Wood   | 1           | 72 lb.         | \$704.10             |
| 4WSP18-51  | 51" Swing Out Pantry (w/Hardware) Single                              | 12" (305 mm) W x 7 1/2" (191 mm) D x 51 1/4" (1302 mm) H | Wood   | 1           | 29 lb.         | \$213.50             |
| 4WDP18-51  | 51" Pantry Door Unit (w/Hardware) Single                              | 12" (305 mm) W x 4" (102 mm) D x 51 1/4" (1302 mm) H     | Wood   | 1           | 19 lb.         | \$166.15             |
| 4WP18-51-KIT   | 51" Swing Out Pantry Kit - Includes (2) 4WSP18-51 and (2) 4WDP18-51   |  | Wood   | 1           | 105 lb.        | \$747.50             |
| 4WSP18-57*   | 57" Swing Out Pantry (w/Hardware) Single                              | 12" (305 mm) W x 7 1/2" (191 mm) D x 57" (1448 mm) H     | Wood   | 1           | 23 lb.         | \$221.00             |
| 4WDP18-57*   | 57" Pantry Door Unit (w/Hardware) Single                              | 12" (305 mm) W x 4" (102 mm) D x 57" (1448 mm) H         | Wood   | 1           | 23 lb.         | \$167.60             |
| 4WP18-57-KIT*  | 57" Swing Out Pantry Kit - Includes (2) 4WDP18-57 and (2) 4WSP18-57   |  | Wood   | 1           | 101 lb.        | \$752.85             |

\* Top Rail NOT included with these models.



## 5200 MP SERIES

### SOFT-CLOSE PULLOUT PANTRY

- Available in three heights and two widths
- Feature adjustable maple shelves with Stylinox™, an anti-skid transparent coating
- 250 lb. rated soft-closing slide
- Door mountable
- Kit packaged
- See page 128 for base version

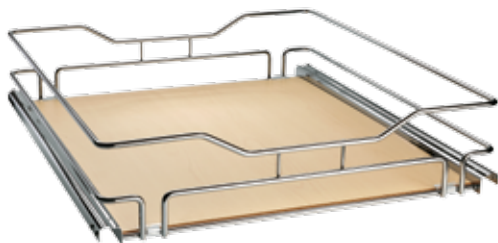

TALL AND PANTRY  
ACCESSORIES



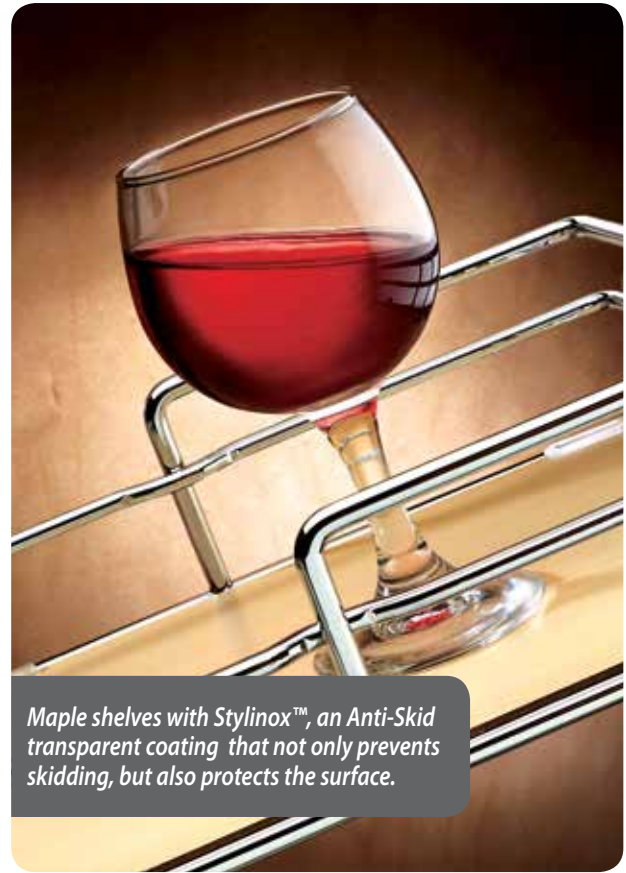

| PRODUCT DIMENSIONS |                             |                             |                              |                              |         |
|--------------------|-----------------------------|-----------------------------|------------------------------|------------------------------|---------|
| PART #             | WIDTH                       | DEPTH                       | HEIGHT (MIN)                 | HEIGHT (MAX)                 | BASKETS |
| 5225-09-MP         | 8 $\frac{5}{8}$ " (219 mm)  | 19 $\frac{1}{2}$ " (495 mm) | 26 $\frac{3}{4}$ " (680 mm)  | 35" (890 mm)                 | 3       |
| 5258-09-MP         | 8 $\frac{5}{8}$ " (219 mm)  | 19 $\frac{1}{2}$ " (495 mm) | 59 $\frac{1}{2}$ " (1510 mm) | 66 $\frac{7}{8}$ " (1700 mm) | 5       |
| 5258-14-MP         | 14 $\frac{1}{2}$ " (369 mm) | 19 $\frac{1}{2}$ " (495 mm) | 59 $\frac{1}{2}$ " (1510 mm) | 66 $\frac{7}{8}$ " (1700 mm) | 5       |
| 5273-09-MP         | 8 $\frac{5}{8}$ " (219 mm)  | 19 $\frac{1}{2}$ " (495 mm) | 74 $\frac{7}{8}$ " (1900 mm) | 81 $\frac{7}{8}$ " (2080 mm) | 6       |
| 5273-14-MP         | 14 $\frac{1}{2}$ " (369 mm) | 19 $\frac{1}{2}$ " (495 mm) | 74 $\frac{7}{8}$ " (1900 mm) | 81 $\frac{7}{8}$ " (2080 mm) | 6       |

Individual Baskets Dimensions:

Width = Net Minimum Width from chart

Depth = 17-1/4" (439 mm), Height = 3" (77 mm)



| PRODUCT #                               | DESCRIPTION                     | BASKET WIDTH                | FRAME HEIGHT | OVERALL DEPTH | FINISH       | SET PER CTN | WHT PER CARTON | SUGGESTED LIST PRICE |
|---|---------------------------------|-----------------------------|--------------|---------------|--------------|-------------|----------------|----------------------|
| Maple Pull-Out Pantry (Individual Pack) |                                 |                             |              |               |              |             |                |                      |
| 5225-09-MP                              | 3 Baskets/2 Door Mount Brackets | 8 $\frac{5}{8}$ " (219 mm)  | See Above    | 20" (508 mm)  | Maple/Chrome | 1           | 49 lb.         | \$1,022.10           |
| 5258-09-MP                              | 5 Baskets/3 Door Mount Brackets | 8 $\frac{5}{8}$ " (219 mm)  | See Above    | 20" (508 mm)  | Maple/Chrome | 1           | 67 lb.         | \$1,353.70           |
| 5258-14-MP                              | 5 Baskets/3 Door Mount Brackets | 14 $\frac{1}{2}$ " (369 mm) | See Above    | 20" (508 mm)  | Maple/Chrome | 1           | 78 lb.         | \$1,440.00           |
| 5273-09-MP                              | 6 Baskets/4 Door Mount Brackets | 8 $\frac{5}{8}$ " (219 mm)  | See Above    | 20" (508 mm)  | Maple/Chrome | 1           | 76 lb.         | \$1,586.30           |
| 5273-14-MP                              | 6 Baskets/4 Door Mount Brackets | 14 $\frac{1}{2}$ " (369 mm) | See Above    | 20" (508 mm)  | Maple/Chrome | 1           | 88 lb.         | \$1,776.10           |

**NOTE:** All pantry kits are packaged with frame, baskets, and door mounting brackets in one carton. 250 lb. rated Full-Extension slides. (See above for more information.) Baskets are adjustable, first basket mounts on top of the slide, 6" (152 mm) from floor, holes then available every 4" (102 mm) above that.



## 5700 SERIES

### SOFT-CLOSE PULLOUT PANTRY

- Available in a variety of sizes
- Glides quietly on 250 lb. rated slide system
- Features micro-adjustment door mounting brackets
- Includes top and bottom slide covers
- Kit packaged with frame, baskets and door mounting brackets in one carton





ADJUSTABLE FRAME HEIGHT

|            | PRODUCT DIMENSIONS                        |              |  |   |         |
|------------|---|--------------|--|---|---------|
| PART #     | WIDTH                                     | DEPTH        | HEIGHT (MIN)                                 | HEIGHT (MAX)                                | BASKETS |
| 5743-09 CR | 8 <sup>7</sup> / <sub>8</sub> " (226 mm)  | 20" (508 mm) | 43 <sup>13</sup> / <sub>32</sub> " (1102 mm) | 50 <sup>3</sup> / <sub>4</sub> " (1289 mm)  | 4       |
| 5743-14 CR | 14 <sup>3</sup> / <sub>4</sub> " (375 mm) | 20" (508 mm) | 43 <sup>13</sup> / <sub>32</sub> " (1102 mm) | 50 <sup>3</sup> / <sub>4</sub> " (1289 mm)  | 4       |
| 5743-20 CR | 20 <sup>5</sup> / <sub>8</sub> " (524 mm) | 20" (508 mm) | 43 <sup>13</sup> / <sub>32</sub> " (1102 mm) | 50 <sup>3</sup> / <sub>4</sub> " (1289 mm)  | 4       |
| 5750-09 CR | 8 <sup>7</sup> / <sub>8</sub> " (226 mm)  | 20" (508 mm) | 50 <sup>3</sup> / <sub>4</sub> " (1289 mm)   | 58 <sup>3</sup> / <sub>32</sub> " (1480 mm) | 4       |
| 5750-14 CR | 14 <sup>3</sup> / <sub>4</sub> " (375 mm) | 20" (508 mm) | 50 <sup>3</sup> / <sub>4</sub> " (1289 mm)   | 58 <sup>3</sup> / <sub>32</sub> " (1480 mm) | 4       |
| 5750-20 CR | 20 <sup>5</sup> / <sub>8</sub> " (524 mm) | 20" (508 mm) | 50 <sup>3</sup> / <sub>4</sub> " (1289 mm)   | 58 <sup>3</sup> / <sub>32</sub> " (1480 mm) | 4       |
| 5758-09 CR | 8 <sup>7</sup> / <sub>8</sub> " (226 mm)  | 20" (508 mm) | 58 <sup>1</sup> / <sub>4</sub> " (1480 mm)   | 65 <sup>3</sup> / <sub>4</sub> " (1670 mm)  | 5       |
| 5758-14 CR | 14 <sup>3</sup> / <sub>4</sub> " (375 mm) | 20" (508 mm) | 58 <sup>1</sup> / <sub>4</sub> " (1480 mm)   | 65 <sup>3</sup> / <sub>4</sub> " (1670 mm)  | 5       |
| 5758-20 CR | 20 <sup>5</sup> / <sub>8</sub> " (524 mm) | 20" (508 mm) | 58 <sup>1</sup> / <sub>4</sub> " (1480 mm)   | 65 <sup>3</sup> / <sub>4</sub> " (1670 mm)  | 5       |
| 5773-04 CR | 4 <sup>1</sup> / <sub>8</sub> " (105 mm)  | 20" (508 mm) | 73 <sup>3</sup> / <sub>8</sub> " (1870 mm)   | 80 <sup>3</sup> / <sub>4</sub> " (2051 mm)  | 6       |
| 5773-09 CR | 8 <sup>7</sup> / <sub>8</sub> " (226 mm)  | 20" (508 mm) | 73 <sup>3</sup> / <sub>8</sub> " (1870 mm)   | 80 <sup>3</sup> / <sub>4</sub> " (2051 mm)  | 6       |
| 5773-14 CR | 14 <sup>3</sup> / <sub>4</sub> " (375 mm) | 20" (508 mm) | 73 <sup>3</sup> / <sub>8</sub> " (1870 mm)   | 80 <sup>3</sup> / <sub>4</sub> " (2051 mm)  | 6       |
| 5773-20 CR | 20 <sup>5</sup> / <sub>8</sub> " (524 mm) | 20" (508 mm) | 73 <sup>3</sup> / <sub>8</sub> " (1870 mm)   | 80 <sup>3</sup> / <sub>4</sub> " (2051 mm)  | 6       |

Individual Baskets Dimensions:

Width = Net Minimum Width from chart

Depth = 17-1/4" (438 mm), Height = 3" (77 mm)



ADJUSTABLE DOOR MOUNT BRACKETS

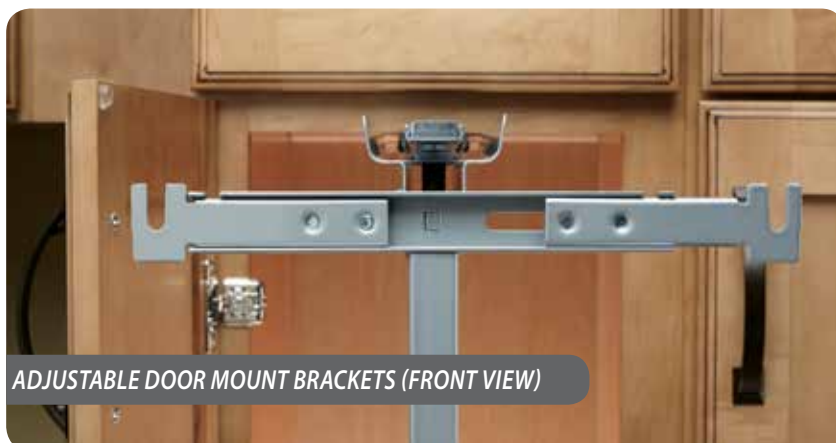

ADJUSTABLE DOOR MOUNT BRACKETS (FRONT VIEW)

| PRODUCT #                             | DESCRIPTION                     | BASKET WIDTH                | FRAME HEIGHT | OVERALL DEPTH | FINISH | SET PER CTN | WHT PER CARTON | SUGGESTED LIST PRICE |
|---------------------------------------|---------------------------------|-----------------------------|--------------|---------------|--------|-------------|----------------|----------------------|
| Wire Pullout Pantry (Individual Pack) |                                 |                             |              |               |        |             |                |                      |
| 5743-09 CR                            | 4 Baskets/2 Door Mount Brackets | 8 $\frac{7}{8}$ " (226 mm)  | See Above    | 20" (508 mm)  | Chrome | 1           | 46 lb.         | \$867.70             |
| 5743-14 CR                            | 4 Baskets/2 Door Mount Brackets | 14 $\frac{3}{4}$ " (375 mm) | See Above    | 20" (508 mm)  | Chrome | 1           | 49 lb.         | \$924.80             |
| 5743-20 CR                            | 4 Baskets/2 Door Mount Brackets | 20 $\frac{5}{8}$ " (524 mm) | See Above    | 20" (508 mm)  | Chrome | 1           | 53 lb.         | \$1,006.30           |
| 5750-09 CR                            | 4 Baskets/2 Door Mount Brackets | 8 $\frac{7}{8}$ " (226 mm)  | See Above    | 20" (508 mm)  | Chrome | 1           | 49 lb.         | \$941.05             |
| 5750-14 CR                            | 4 Baskets/2 Door Mount Brackets | 14 $\frac{3}{4}$ " (375 mm) | See Above    | 20" (508 mm)  | Chrome | 1           | 56 lb.         | \$1,006.30           |
| 5750-20 CR                            | 4 Baskets/2 Door Mount Brackets | 20 $\frac{5}{8}$ " (524 mm) | See Above    | 20" (508 mm)  | Chrome | 1           | 60 lb.         | \$1,087.65           |
| 5758-09 CR                            | 5 Baskets/3 Door Mount Brackets | 8 $\frac{7}{8}$ " (226 mm)  | See Above    | 20" (508 mm)  | Chrome | 1           | 48 lb.         | \$965.40             |
| 5758-14 CR                            | 5 Baskets/3 Door Mount Brackets | 14 $\frac{3}{4}$ " (375 mm) | See Above    | 20" (508 mm)  | Chrome | 1           | 58 lb.         | \$1,030.65           |
| 5758-20 CR                            | 5 Baskets/3 Door Mount Brackets | 20 $\frac{5}{8}$ " (524 mm) | See Above    | 20" (508 mm)  | Chrome | 1           | 65 lb.         | \$1,120.15           |
| 5773-04 CR                            | 6 Baskets/4 Door Mount Brackets | 4 $\frac{1}{8}$ " (105 mm)  | See Above    | 20" (508 mm)  | Chrome | 1           | 61 lb.         | \$981.80             |
| 5773-09 CR                            | 6 Baskets/4 Door Mount Brackets | 8 $\frac{7}{8}$ " (226 mm)  | See Above    | 20" (508 mm)  | Chrome | 1           | 66 lb.         | \$1,030.65           |
| 5773-14 CR                            | 6 Baskets/4 Door Mount Brackets | 14 $\frac{3}{4}$ " (375 mm) | See Above    | 20" (508 mm)  | Chrome | 1           | 75 lb.         | \$1,112.00           |
| 5773-20 CR                            | 6 Baskets/4 Door Mount Brackets | 20 $\frac{5}{8}$ " (524 mm) | See Above    | 20" (508 mm)  | Chrome | 1           | 82 lb.         | \$1,226.00           |

**NOTE:** All pantry kits are packaged with frame, baskets, and door mounting brackets in one carton. 250 lb. rated Full-Extension slides. **Ship by truck.** (See above for more information.) Baskets are adjustable, first basket mounts on top of the slide, 6" (152 mm) from floor, holes then available every 4" (102 mm) above that.



# 5722 SERIES

## CHEF'S ROLL-OUT PANTRY WITH DOOR STORAGE

- Designed to maximize every inch of your 36" pantry
- 20 large interior chrome baskets
- 10 door mount baskets
- Can be rearranged to accommodate a variety of products
- Pivot sliding hardware allows full access to the back shelves

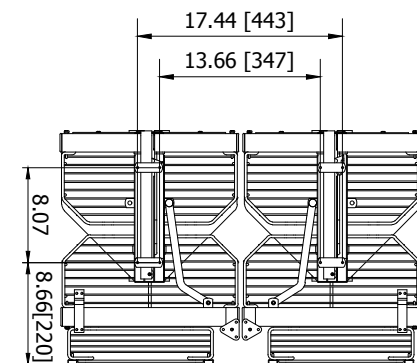
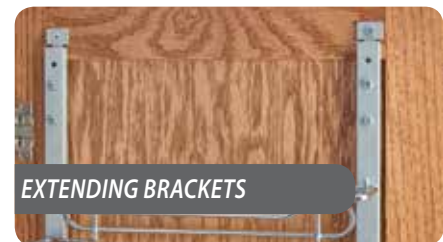
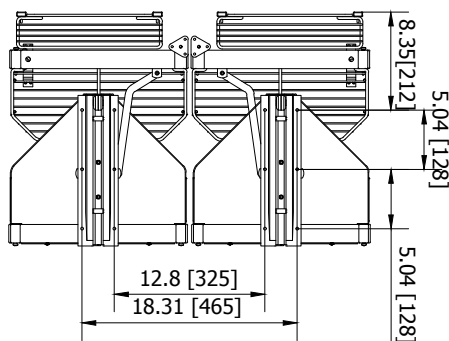
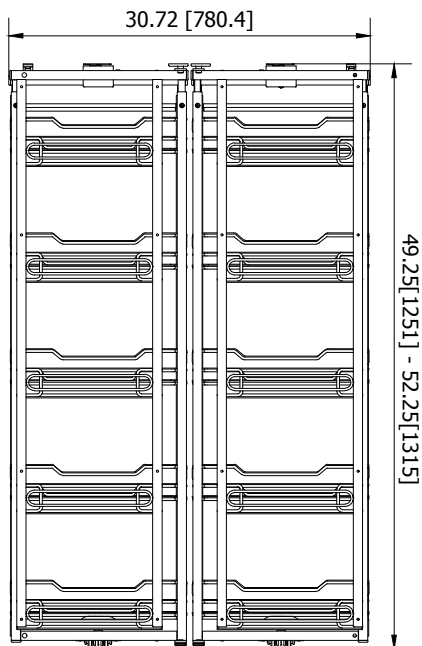

| PRODUCT #  | DESCRIPTION            | PRODUCT DIMENSIONS   | FINISH | SET PER CTN | WHT PER CARTON | SUGGESTED LIST PRICE |
|--|------------------------|--|--------|-------------|----------------|----------------------|
| Chef's Pantry and Door Storage (Individual Pack) |                        |  |        |             |                |                      |
| 5722-36CR  | Chef's Roll-Out Pantry | 30¾" (780 mm) W x 19⅞" (504 mm) D x 49¼" - 52¼" (1251-1315 mm) H | Chrome | 1           | 162 lb.        | \$1,729.25           |

**CONTAINS: 5722-36CR** - Chrome plated pantry frame with all pivot and mounting hardware. (20) large interior baskets, (10) small door baskets, and 2 sets of door mount brackets.

**NOTE:** Chef's Pantry and Door Storage is available in chrome only. 220 lb. Weight Capacity. **Ship by truck**





## 4265 SERIES

### WOOD D-SHAPED PANTRY SETS

#### FIVE SHELF SUSAN SET

- Designed for pantry/tall cabinet applications
- Feature a 5/8" thick high-density multi-ply shelf
- 1" high solid wood rim and
- UV-cured clear coat finish

#### STORAGE TRAYS

- Wood Storage Trays are available in 11", 14" and 20" width trays
- Feature a sleek design constructed of beautiful maple with chrome accents.
- Install easily on 26" or 58" standards with standard clips (sold separately)

TALL AND PANTRY ACCESSORIES

Three Sizes Available 11", 14" and 20"  
(Shown with optional doortrays,  
standards and clips 6232-58-4528-52)

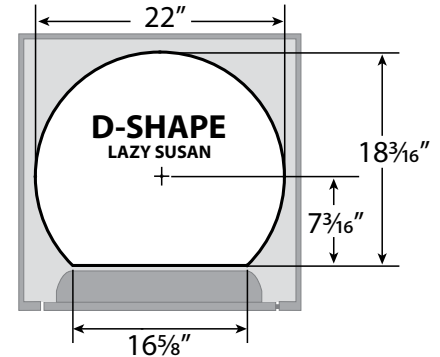

| PRODUCT #  | DESCRIPTION                                 | PRODUCT DIMENSIONS  | FINISH          | SET PER CTN | WHT PER CARTON | SUGGESTED LIST PRICE |
|--|---|---|-----------------|-------------|----------------|----------------------|
| 5 Shelf D-Shape Pantry Sets and Hardware, Independent Rotating (Individual Pack) |   |   |                 |             |                |                      |
| 4265-22-52   | 5 Shelf D-Shape Set                         | 22" (560 mm) Diameter                                     | Wood            | 1           | 35.5 lb.       | \$657.45             |
| Door Storage Trays (Bulk Pack)   |   |   |                 |             |                |                      |
| 4235-11-5  | 11" Wood Door Storage Tray w/Screw In Clips | 10 3/4" (273 mm) W x 4 1/4" (108 mm) D x 3 3/8" (91 mm) H | Wood            | 5 tray      | 1.65 lb.       | \$27.25 ea.          |
| 4235-14-5  | 14" Wood Door Storage Tray w/Screw In Clips | 13 3/4" (349 mm) W x 4 1/4" (108 mm) D x 3 3/8" (91 mm) H | Wood            | 5 tray      | 12 lb.         | \$29.15 ea.          |
| 4235-20-5  | 20" Wood Door Storage Tray w/Screw In Clips | 19 3/4" (502 mm) W x 4 1/4" (108 mm) D x 3 3/8" (91 mm) H | Wood            | 5 tray      | 18 lb.         | \$33.80 ea.          |
| Hardware   |   |   |                 |             |                |                      |
| 6232-26-4528-52  | Pair Aluminum Standards & 4 Clips           | 26" (1473 mm) L   | Bright Aluminum | 1 pr.       | 1 lb.          | \$44.25              |
| 6232-58-4528-52  | Pair Aluminum Standards & 10 Clips          | 58" (1473 mm) L   | Bright Aluminum | 1 pr.       | 2 lb.          | \$61.75              |

#### 4265 SERIES CONTAINS:

(5) shelves, w/ (5) positioning base assemblies and telescoping shaft to accommodate 56"-62" (1423-1575 mm) Inner Cabinet Height. 1" (26 mm) diameter shaft system.



# 6265 SERIES

## D PANTRY SETS

- Include five polymer D-shaped shelves
- Independent rotating system
- Available in white or almond

See page 268 for lip dimensions

**6265 Lower Pantry  
Five shelf set**  
6265-2200-41\*\*-52

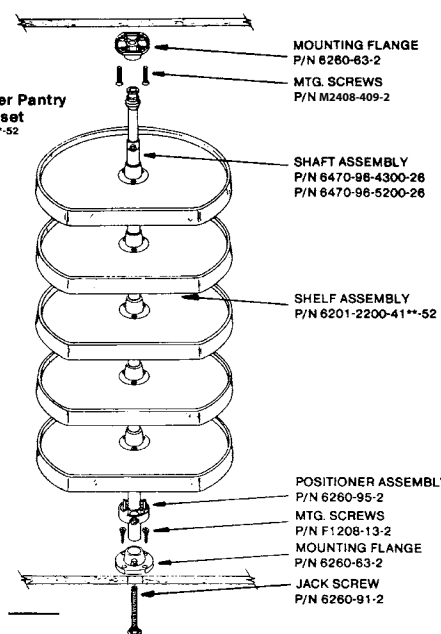

**DOOR STORAGE SOLD SEPARATELY!**



**FEATURING CHROME HUBS AND HARDWARE**

| PRODUCT #  | DESCRIPTION               | PRODUCT DIMENSIONS  | FINISH          | SET PER CTN | WHT PER CARTON | SUGGESTED LIST PRICE |
|--|---------------------------|---|-----------------|-------------|----------------|----------------------|
| 5 Shelf D-Shape Pantry Sets and Hardware, Independent Rotating (Individual Pack) |                           |   |                 |             |                |                      |
| 6265-22-**-52  | 5 Shelf D-Shape Set       | 22" (560 mm) Diameter                                     | Polymer         | 1           | 28 lb.         | \$349.30             |
| 6232-58-4528-52  | Pair Standards & 10 Clips | 58" (1473 mm) L   | Bright Aluminum | 1 pr.       | 2 lb.          | \$61.75              |
| 6235-20-**-52  | 5 Door Storage Trays      | 19 3/4" (502 mm) W x 4 1/4" (110 mm) D x 3 1/8" (95 mm) H | Polymer         | 1           | 5 lb.          | \$72.80              |

**6265 SERIES CONTAINS:** (5) shelves, w/ (5) positioning base assemblies and telescoping shaft to accommodate 56"-62" (1423-1575 mm) Inner Cabinet Height

**NOTES:** 1" (26 mm) diameter shaft system \*\*Product available in two colors: 11 White & 15 Almond

**Door Storage Trays:** When ordering you must purchase the standards and the trays to complete the set.

## 6065 SERIES

### ROUND PANTRY SETS

- Include five polymer full circle shelves
- Independent rotating system
- Available in 16" and 18" diameters
- Can also be special ordered in 20", 24", 28", and 32" diameters
- Available in white or almond color

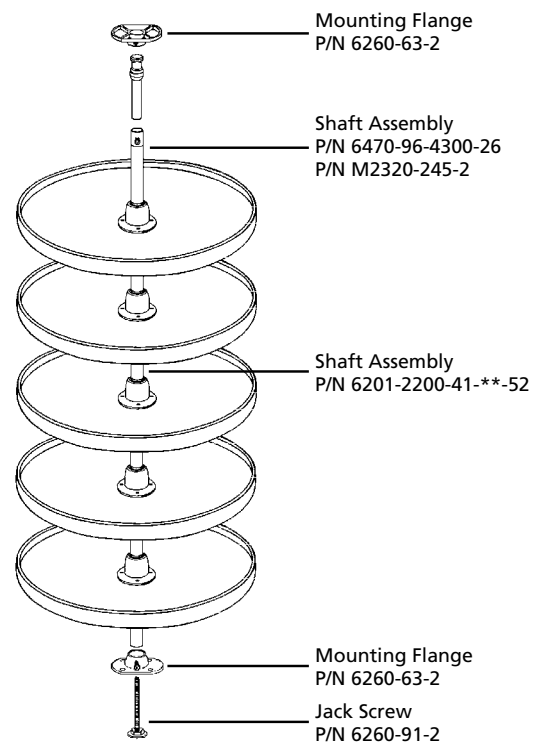

(Shown with optional doortrays, standards and clips 6232-58-4528-52)

TALL AND PANTRY  
ACCESSORIES

| PRODUCT #  | DESCRIPTION               | PRODUCT DIMENSIONS                               | FINISH          | SET PER CTN | WHT PER CARTON | SUGGESTED LIST PRICE |
|--|---------------------------|--|-----------------|-------------|----------------|----------------------|
| 5 Shelf Full Circle Pantry Sets and Hardware, Independent Rotating (Individual Pack) |                           |  |                 |             |                |                      |
| 6065-16-**-52  | 5 Shelf Full-Circle Set   | 16" (410 mm) Diameter                            | Polymer         | 1           | 24 lb.         | \$346.70             |
| 6065-18-**-52  | 5 Shelf Full-Circle Set   | 18" (457 mm) Diameter                            | Polymer         | 1           | 29 lb.         | \$379.30             |
| Hardware   |                           |  |                 |             |                |                      |
| 6232-58-4528-52  | Pair Standards & 10 Clips | 58" (1473 mm) L                                  | Bright Aluminum | 1 pr.       | 2 lb.          | \$61.75              |
| Door Storage Trays   |                           |  |                 |             |                |                      |
| 6235-08-**-52  | 5 Door Storage Trays      | 7½" (181 mm) W x 4¼" (110 mm) D x 3¾" (95 mm) H  | Polymer         | 1           | 2 lb.          | \$55.55              |
| 6235-14-**-52  | 5 Door Storage Trays      | 13¾" (350 mm) W x 4¼" (110 mm) D x 3¾" (95 mm) H | Polymer         | 1           | 4 lb.          | \$60.20              |

#### 6065 SERIES CONTAINS:

**6065** Five (5) shelves, (4) collar assemblies, telescoping shaft 9¼" (235 mm) upper & 52½" (1334 mm) lower assembly to accommodate 56"-62" (1423-1575 mm) Inner Cabinet Height and mounting hardware.

#### NOTES:

Also available by special order (6065): 20" (508 mm) – 24" (610 mm) – 28" (711 mm) – 32" (813 mm) Full Circle Shelves in multiple shelf sets. 1" (26 mm) diameter shaft system  
Door storage trays sold separately.

**Door Storage Trays:** When ordering you must purchase the standards, and the trays to complete the set.

\*\* Product available in two colors: 11 White & 15 Almond



# POLYMER SERIES WALK-IN PANTRY CABINET LAZY SUSANS

TALL AND PANTRY  
ACCESSORIES

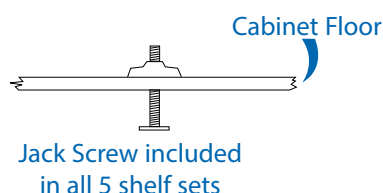
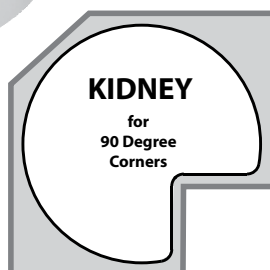
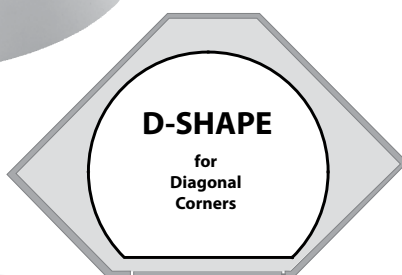

**SPECIAL ORDER ITEMS  
PLEASE ALLOW TWO-WEEK LEAD TIME.**

| PRODUCT #  | DESCRIPTION                        | PRODUCT DIMENSIONS    | FINISH        | SET PER CTN | WHT PER CARTON | SUGGESTED LIST PRICE |
|--|------------------------------------|-----------------------|---------------|-------------|----------------|----------------------|
| 5 Shelf Pantry Sets and Rotating Hardware, Shaft Sold Separately (Individual Pack) |                                    |                       |               |             |                |                      |
| 6265-20-**-50  | 5 Shelf D-Shape Set (no post)      | 20" (508 mm) Diameter | Polymer Trays | 1           | 20 lb.         | \$312.50             |
| 6465-18-**-50  | 5 Shelf Kidney Shape Set (no post) | 18" (457 mm) Diameter | Polymer Trays | 1           | 22 lb.         | \$286.50             |
| 6465-24-**-50  | 5 Shelf Kidney Shape Set (no post) | 24" (610 mm) Diameter | Polymer Trays | 1           | 24 lb.         | \$315.10             |
| Shaft (Individual Pack)  |                                    |                       |               |             |                |                      |
| 6370-96-7008-26-52   | 70½" Shaft with bushing            | 70½" (1791 mm) Length | Chrome        | 1           | 5 lb.          | \$61.90              |
| Single Shelf Pantry Sets, Post Included (Individual Pack)                          |                                    |                       |               |             |                |                      |
| 6221-20-**-52  | Single Shelf D-Shape Tray          | 20" (508 mm) Diameter | Polymer Trays | 1           | 5 lb.          | \$60.45              |
| 6421-18-**-52  | Single Shelf Kidney Shape Tray     | 18" (457 mm) Diameter | Polymer Trays | 1           | 4 lb.          | \$53.05              |
| 6421-24-**-52  | Single Shelf Kidney Shape Tray     | 24" (610 mm) Diameter | Polymer Trays | 1           | 4 lb.          | \$56.70              |

**CONTAINS:** (5) shelves, w/ (5) positioning base assemblies, mounting flange and jack screw. (Lower Shaft Sold Separately) - Includes Upper Shaft  
**NOTES:** 1" (26 mm) diameter shaft system \*\*Product available in two colors: 11 White and 15 Almond.

## WOOD SERIES WALK-IN PANTRY CABINET LAZY SUSANS

- Include five wood shelves
- Independent rotating system
- The shelves are available in 20" or 24" diameters



**SPECIAL ORDER ITEMS  
PLEASE ALLOW TWO-WEEK LEAD TIME.**



4WLS221 - 20"



4WLS421 - 24"

TALL AND PANTRY  
ACCESSORIES

| PRODUCT #  | DESCRIPTION                        | PRODUCT DIMENSIONS    | FINISH | SET PER CTN | WHT PER CARTON | SUGGESTED LIST PRICE |
|--|------------------------------------|-----------------------|--------|-------------|----------------|----------------------|
| 5 Shelf Pantry Sets and Rotating Hardware, Shaft Sold Separately (Individual Pack) |                                    |                       |        |             |                |                      |
| 4265-20-50   | 5 Shelf D-Shape Set (no post)      | 20" (508 mm) Diameter | Wood   | 1           | 28 lb.         | \$607.85             |
| 4465-24-50   | 5 Shelf Kidney Shape Set (no post) | 24" (609 mm) Diameter | Wood   | 1           | 37 lb.         | \$731.25             |
| Shaft (Individual Pack)  |                                    |                       |        |             |                |                      |
| 6370-96-7008-26-52   | 70½" Shaft with bushing            | 70½" (1791 mm) Length | Chrome | 1           | 5 lb.          | \$61.90              |
| Single Shelf Pantry Sets, Post Included (Individual Pack)                          |                                    |                       |        |             |                |                      |
| 4WLS221-20-52  | Single Shelf D-Shape Set           | 20" (508 mm) Diameter | Wood   | 1           | 8 lb.          | \$104.70             |
| 4WLS421-24-52  | Single Shelf Kidney Shape Set      | 24" (609 mm) Diameter | Wood   | 1           | 10 lb.         | \$134.10             |

**CONTAINS:** (5) shelves, w/ (5) positioning base assemblies, mounting flange and jack screw. (Lower Shaft Sold Separately) - Includes Upper Shaft

**NOTES:** 1" (26 mm) diameter shaft system