

WALL



REV-A-SHELF®

How do you make more room in a confined space like a wall cabinet? Or how do you use all the space in your cabinet when you can't reach the shelves? Answer - Add Rev-A-Shelf Wall Accessories. Our classic door mount spice racks and storage shelves expand your limited space with selections of wire, polymer and wood. And now everyone can reach the shelves in your wall cabinet with our revolutionary chrome Pull-Down Shelving System. This popular kitchen convenience is one of the many innovative products introduced as Rev-A-Shelf continues to change the way you think about cabinet organization!

WALL

5708 SERIES

ABOVE APPLIANCE PULLOUT

- Fits 24" deep wall cabinetry
- Minimum cabinet opening width: 15"
- Minimum cabinet height: 15"
- Reversible design; attaches to either side of cabinet
- Adjustable door mount brackets for perfect fit



For video visit:
rev-a-shelf.com/videos

NEW!

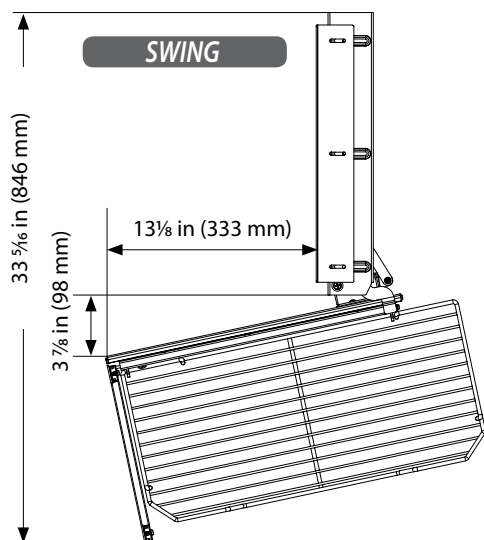

FRONT

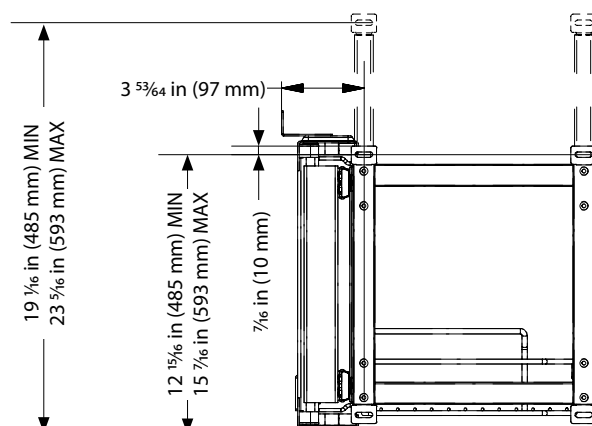

SIDE

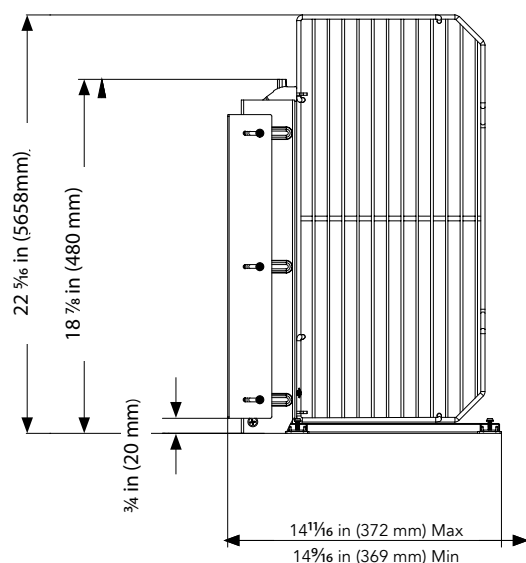
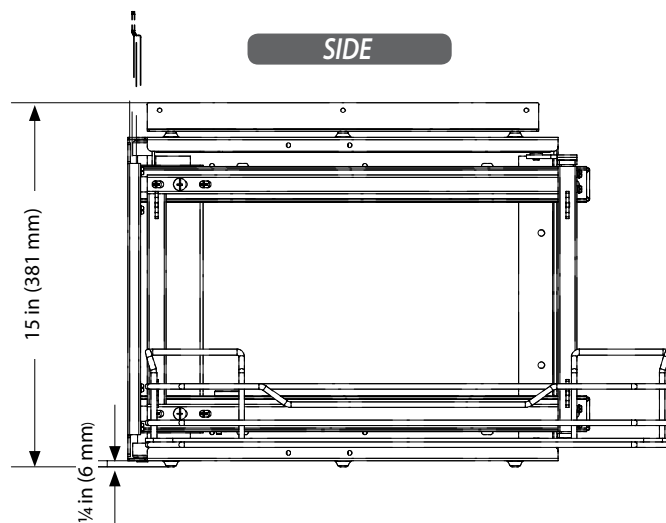

WALL
ACCESSORIES

PRODUCT #	DESCRIPTION	PRODUCT DIMENSIONS	FINISH	SET PER CTN	WHT PER CARTON	SUGGESTED LIST PRICE
Above Appliance Pullout						
5708-15CR	Above Appliance Pullout	13"(330 mm) W x 19"(483 mm) D x 15"(394 mm) H	Chrome	1	25 lb.	\$435.00



For video visit:
rev-a-shelf.com/videos

4MR SERIES

MAIL ORGANIZER

- Designed for 18" wall cabinets
- Available in White or Natural
- Holds standard and flat envelopes
- Eight key hooks
- Patented adjustable mounting brackets (US Patent No. US 7,204,569)
- Mounts inside wall cabinets, end of a run or on a wall.

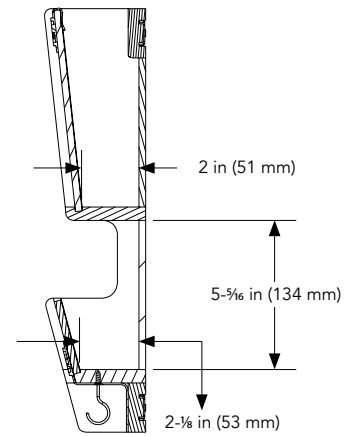

SIDE

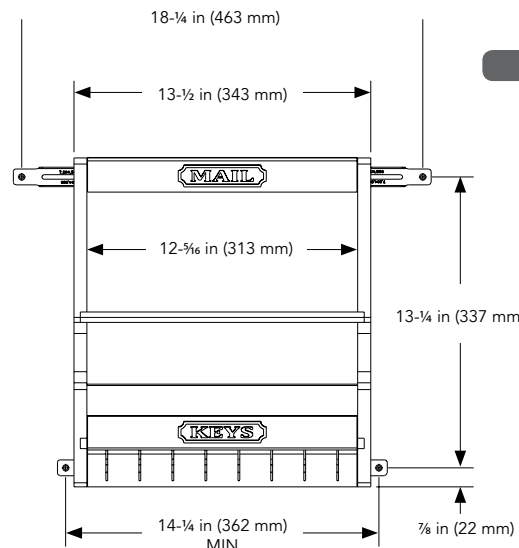

FRONT

ALSO AVAILABLE IN WHITE!

WALL
ACCESSORIES

PRODUCT #	DESCRIPTION	PRODUCT DIMENSIONS	FINISH	SET PER CTN	WHT PER CARTON	SUGGESTED LIST PRICE
Mail Organizer						
4MR-18-1	Door Mount Mail Organizer for 18 in wall Cabinet	13½"(343 mm) W x 3¾"(90 mm)" D x 15"(381 mm) H	Natural	1	6 lb.	\$86.55
4MR-18W-1	Door Mount Mail Organizer for 18 in wall Cabinet	13½"(343 mm) W x 3¾"(90 mm)" D x 15"(381 mm) H	White	1	6 lb.	\$119.20

4SR SERIES

DOOR MOUNT SPICE RACK

- Available for Wall 15", 18" and 21" cabinets
- Can house spice bottles up to 2-1/4" diameter
- Made of attractive maple hardwood
- Installs with just four screws

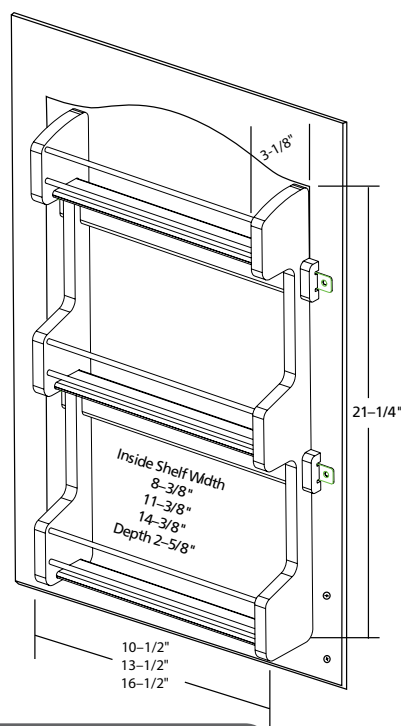

Minimum Cabinet Opening:

4SR-15	11 3/4"
4SR-18	14 3/4"
4SR-21	17 3/4"



Back View of Adjustable Brackets US PATENT NO: 7,204,569



Up to 5" (2 1/2" each side)
of adjustability, just loosen screws,
adjust, then retighten.

PRODUCT #	DESCRIPTION	PRODUCT DIMENSIONS	FINISH	SET PER CTN	WHT PER CARTON	SUGGESTED LIST PRICE
Door Mount Spice Rack (Individual Pack)						
4SR-15	Wall 15 Door Mount Spice Rack	10 1/2" (267 mm) W x 3 1/8" (81 mm) D x 21 1/4" (540 mm) H	Wood	1	3 lb.	\$45.40
4SR-18	Wall 18 Door Mount Spice Rack	13 1/2" (343 mm) W x 3 1/8" (81 mm) D x 21 1/4" (540 mm) H	Wood	1	4 lb.	\$54.40
4SR-21	Wall 21 Door Mount Spice Rack	16 1/2" (419 mm) W x 3 1/8" (81 mm) D x 21 1/4" (540 mm) H	Wood	1	5 lb.	\$63.95

CONTAINS:

(1) Door Mount Spice Rack and 4 Screws, AMB BRACKETS: US PATENT NO: 7,204,569

NOTE:

Height between shelves is 8 5/8" (219 mm)

4ASR SERIES

ADJUSTABLE DOOR MOUNT SPICE RACK

- Available for Wall 15", 18" and 21" cabinets
- Can house spice bottles up to 2-1/4" diameter
- Made of attractive maple hardwood
- Installs with just four screws
- Features adjustable shelves

Minimum Cabinet Opening:

4ASR-15	11"
4ASR-18	14"
4ASR-21	16 3/4"

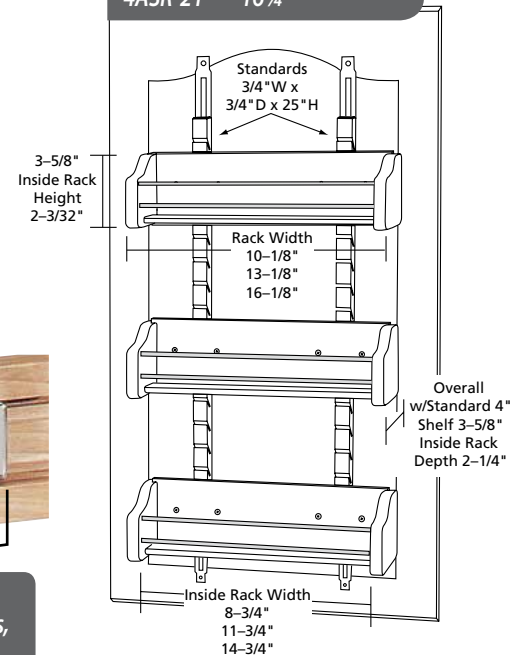

Back View of Adjustable Brackets US PATENT NO: 7,204,569



BRACKET ON BACK OF SHELF FOR ATTACHING TO STANDARDS



Up to 5" (2 1/2" each side) of adjustability, just loosen screws, adjust, then retighten.

PRODUCT #	DESCRIPTION	PRODUCT DIMENSIONS	FINISH	SET PER CTN	WHT PER CARTON	SUGGESTED LIST PRICE
Adjustable Door Mount Spice Rack (Individual Pack)						
4ASR-15	Wall 15 Adjustable Door Mount Spice Rack	10 1/8" (257 mm) W x 4" (102 mm) D x 25" (635 mm) H	Wood	1	4 lb.	\$95.70
4ASR-18	Wall 18 Adjustable Door Mount Spice Rack	13 1/8" (333 mm) W x 4" (102 mm) D x 25" (635 mm) H	Wood	1	5 lb.	\$118.45
4ASR-21	Wall 21 Adjustable Door Mount Spice Rack	16 1/8" (410 mm) W x 4" (102 mm) D x 25" (635 mm) H	Wood	1	6 lb.	\$141.25
Door Mount Spice Rack Components (Bulk Pack)						
4ASR-25STD-20	25" Door Mount Spice Rack Standards		Wood	20	10 lb.	\$10.45 ea.
4ASR-31STD-20	31" Door Mount Spice Rack Standards		Wood	20	12 lb.	\$11.00 ea.
4ASR-37STD-20	37" Door Mount Spice Rack Standards		Wood	20	14 lb.	\$12.35 ea.
4ASR-15BIN-10	Wall 15 Bins ONLY	10 1/8" (257 mm) W x 3 3/8" (92 mm) D x 3 3/8" (92 mm) H	Wood	10	11 lb.	\$25.65 ea.
4ASR-18BIN-10	Wall 18 Bins ONLY	13 1/8" (333 mm) W x 3 3/8" (92 mm) D x 3 3/8" (92 mm) H	Wood	10	13 lb.	\$34.80 ea.
4ASR-21BIN-10	Wall 21 Bins ONLY	16 1/8" (410 mm) W x 3 3/8" (92 mm) D x 3 3/8" (92 mm) H	Wood	10	15 lb.	\$41.20 ea.

CONTAINS: (3) Shelves, (2) 25" Slotted Standards and Screws, AMB BRACKETS: US PATENT NO: 7,204,569

565 SERIES

DOOR MOUNT SPICE RACK

- Available in three different widths
- Features three small tiers to hold spices and one larger tier that can accommodate canned goods
- Made of heavy-gauge white wire
- Easily installs with just four screws

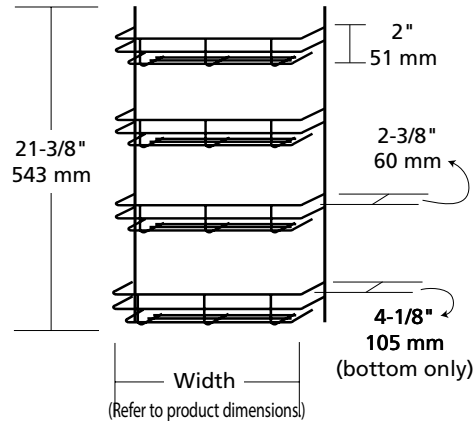

PRODUCT #	DESCRIPTION	PRODUCT DIMENSIONS	FINISH	SET PER CTN	WHT PER CARTON	SUGGESTED LIST PRICE
Door Mount Spice Rack (Individual Pack)						
565-8-52	Door Mount Spice Rack	7 $\frac{7}{8}$ " (200 mm) W x 2 $\frac{3}{8}$ " (61 mm) – 4 $\frac{1}{8}$ " (105 mm) D x 21 $\frac{3}{8}$ " (543 mm) H	White Wire	1	2 lb.	\$41.05
565-10-52	Door Mount Spice Rack	10 $\frac{1}{8}$ " (270 mm) W x 2 $\frac{3}{8}$ " (61 mm) – 4 $\frac{1}{8}$ " (105 mm) D x 21 $\frac{3}{8}$ " (543 mm) H	White Wire	1	2 lb.	\$46.85
565-14-52	Door Mount Spice Rack	13 $\frac{3}{8}$ " (346 mm) W x 2 $\frac{3}{8}$ " (61 mm) – 4 $\frac{1}{8}$ " (105 mm) D x 21 $\frac{3}{8}$ " (543 mm) H	White Wire	1	2 lb.	\$48.70
Door Mount Spice Rack (Bulk Pack)						
565-8	Door Mount Spice Rack	7 $\frac{7}{8}$ " (200 mm) W x 2 $\frac{3}{8}$ " (61 mm) – 4 $\frac{1}{8}$ " (105 mm) D x 21 $\frac{3}{8}$ " (543 mm) H	White Wire	20	18 lb.	\$38.15 ea.
565-10	Door Mount Spice Rack	10 $\frac{1}{8}$ " (270 mm) W x 2 $\frac{3}{8}$ " (61 mm) – 4 $\frac{1}{8}$ " (105 mm) D x 21 $\frac{3}{8}$ " (543 mm) H	White Wire	20	26 lb.	\$43.95 ea.
565-14	Door Mount Spice Rack	13 $\frac{3}{8}$ " (346 mm) W x 2 $\frac{3}{8}$ " (61 mm) – 4 $\frac{1}{8}$ " (105 mm) D x 21 $\frac{3}{8}$ " (543 mm) H	White Wire	20	30 lb.	\$45.40 ea.

CONTAINS:

(1) wire rack (4) door mount clips and (4) screws

ST/6571 SERIES

DOOR MOUNT SPICE RACK

- Available in 36" or 72" extruded trays
- Can be cut-to-size
- Components include end caps, screws and adhesive (each sold separately)
- Available in white or almond colors

Custom cut trays to length and glue end caps on with Rev-A-Glue. (Included)

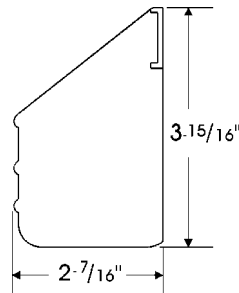
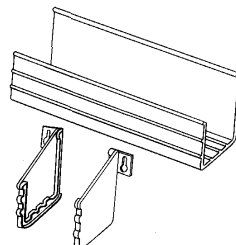

PRODUCT #	DESCRIPTION	PRODUCT DIMENSIONS	FINISH	SET PER CTN	WHT PER CARTON	SUGGESTED LIST PRICE
Door Mount Spice Rack (Individual Pack)						
6571-36-**-4	Trays	36" (914 mm) W x 2 $\frac{1}{8}$ " (62 mm) D x 3 $\frac{15}{16}$ " (100 mm) H	Polymer Trays	20	21 lb.	\$13.50 ea.
6571-72-**-4	Trays	72" (1829 mm) W x 2 $\frac{1}{8}$ " (62 mm) D x 3 $\frac{15}{16}$ " (100 mm) H	Polymer Trays	20	36 lb.	\$32.20 ea.
ST-97-**-4	End Caps, Screws			40 Pr.	4 lb.	\$7.55 pr.
6571-60-52	Tube of Adhesive	2 Gram		1	.1 lb.	\$5.95
6571-61-52	Bottle of Adhesive	1 Ounce		1	.1 lb.	\$30.90

NOTE:

6571: Extruded cut-to-size trays, components must be ordered separately.

****** Trays Available in two colors—11-White, 15-Almond



4WFR SERIES

VERTICAL FOIL RACK

- Designed for 15", 18" and 21" Wall cabinets
- Made from maple and accented with chrome rails
- Features our patented adjustable mounting brackets

US PATENT NO: 7,204,569



ADJUSTABLE MOUNTING BRACKETS
Up to 5" (2-1/2" each side)
of adjustability, just loosen screws,
adjust, then retighten.

Minimum Cabinet Opening:

4WFR-15-1 11"
4WFR-18-1 13 3/4"
4WFR-21-1 16 5/8"

PRODUCT #	DESCRIPTION	PRODUCT DIMENSIONS	FINISH	SET PER CTN	WHT PER CARTON	SUGGESTED LIST PRICE
Vertical Foil Rack (Individual Pack)						
4WFR-15-1	Vertical Foil Rack for 15" Cabinet	10 5/8" (257 mm) W x 4" (102 mm) D x 8" (203 mm) H	Wood	1	2.5 lb.	\$59.60
4WFR-18-1	Vertical Foil Rack for 18" Cabinet	13 5/8" (334 mm) W x 4" (102 mm) D x 8" (203 mm) H	Wood	1	3 lb.	\$64.25
4WFR-21-1	Vertical Foil Rack for 21" Cabinet	16 5/8" (410 mm) W x 4" (102 mm) D x 8" (203 mm) H	Wood	1	3.5 lb.	\$68.75

4WV-411 SERIES

STATIC WOVEN BASKETS

In need of functional decorative bins? Look no further than Rev-A-Shelf's Static Woven Baskets, featuring stylish machine washable canvas liners.

See page 95 for base cabinet version



WALL
ACCESSORIES

PRODUCT #	DESCRIPTION	PRODUCT DIMENSIONS	FINISH	SET PER CTN	WHT PER CARTON	SUGGESTED LIST PRICE
Static Woven Basket (Individual Pack)						
4WV-411-4	Static Woven Baskets	4" (102 mm) W x 10 7/8" (277 mm) D x 4 1/4" (108 mm) H	Eucalyptus	4	4 lb.	\$29.30 ea.

NOTE: 4WB-411 Series Sold as a set of (4), Suggested List Price is per basket. These items are hand-woven baskets, allow 1/8" total variance.

CONTAINS: 4WB-411 Series (4) Woven Baskets and (4) Canvas Liners

432 SERIES WALL FILLER PULLOUT ORGANIZER

- Available for 3" and 6" wall cabinet applications
- Create a functional storage space behind those decorative panels
- Features adjustable shelves with chrome rails
- Full-extension ball-bearing slides
- Three slide design provides stability

5KCUP Accessory

- Holds 44 pods
- Four-screw installation
- Not Available for base cabinet application
- For 3" Fillers only

See page 101 for base cabinet version

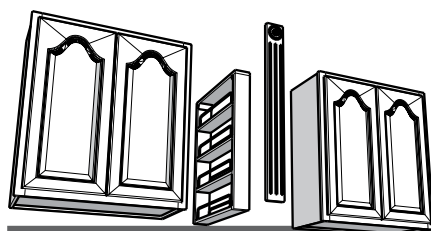

**THIS PRODUCT IS INSTALLED
BETWEEN TWO CABINETS.
ONLY THE FACE MUST BE ADDED!**



PRODUCT #	DESCRIPTION	PRODUCT DIMENSIONS	FINISH	SET PER CTN	WHT PER CARTON	SUGGESTED LIST PRICE
Wall Pullout Filler (Individual Pack)						
432-WF-3C	30" Tall 3" Filler Organizer	3" (76 mm) W x 11½" (283 mm) D x 30" (762 mm) H	Wood	1	12 lb.	\$147.60
432-WF-6C	30" Tall 6" Filler Organizer	6" (152 mm) W x 11½" (283 mm) D x 30" (762 mm) H	Wood	1	19 lb.	\$183.85
432-WF33-3C	33" Tall 3" Filler Organizer	3" (76 mm) W x 11½" (283 mm) D x 33" (838 mm) H	Wood	1	14 lb.	\$152.25
432-WF33-6C	33" Tall 6" Filler Organizer	6" (152 mm) W x 11½" (283 mm) D x 33" (838 mm) H	Wood	1	21 lb.	\$189.65
432-WF36-3C	36" Tall 3" Filler Organizer	3" (76 mm) W x 11½" (283 mm) D x 36" (915 mm) H	Wood	1	16 lb.	\$160.50
432-WF36-6C	36" Tall 6" Filler Organizer	6" (152 mm) W x 11½" (283 mm) D x 36" (915 mm) H	Wood	1	23 lb.	\$197.20
432-WF39-3C	39" Tall 3" Filler Organizer	3" (76 mm) W x 11½" (283 mm) D x 39" (991 mm)H	Wood	1	15 lb.	\$160.95
432-WF39-6C	39" Tall 6" Filler Organizer	6" (152 mm)W x 11½" (283 mm)D x 39" (991 mm) H	Wood	1	24 lb.	\$200.70
432-WF42-3C	42" Tall 3" Filler Organizer	3" (76 mm) W x 11½" (283 mm) D x 42" (1067 mm) H	Wood	1	20 lb.	\$170.80
432-WF42-6C	42" Tall 6" Filler Organizer	6" (152 mm) W x 11½" (283 mm) D x 42" (1067 mm) H	Wood	1	25 lb.	\$207.35
Wall Pullout Accessories						
5KCUP-432-1	K-Cup Accessory to 432 Series 3 in. wall filler	Fits all 432 series 3 in. wall fillers		1	1.6 lb.	\$25.50

434 SERIES WALL FILLER PULLOUT ORGANIZER

- Available in 3" and 6"
- Features full-extension ball-bearing slides
- Magnetic grade stainless steel panel and a variety accessory hooks and pegs included
- Additional accessory hooks and attachable door storage trays can be purchased separately

See page 104 for base version and accessories

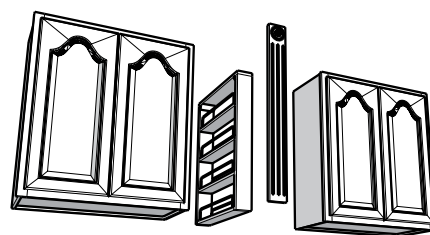

**THIS PRODUCT IS INSTALLED
BETWEEN TWO CABINETS.
ONLY THE FACE MUST BE ADDED!**

**MAGNETIC GRADE
STAINLESS STEEL PANEL**

**WALL
ACCESSORIES**

PRODUCT #	DESCRIPTION	PRODUCT DIMENSIONS	FINISH	SET PER CTN	WHT PER CARTON	SUGGESTED LIST PRICE
Wall Pullout Filler (Individual Pack)						
434-WF-3SS	3" Perforated Filler Organizer	3" (76 mm) W x 11½" (283 mm) D x 30" (762 mm) H	Wood	1	14 lb.	\$234.05
434-WF-6SS	6" Perforated Filler Organizer	6" (152 mm) W x 11½" (283 mm) D x 30" (762 mm) H	Wood	1	24 lb.	\$284.50

CONTAINS: 1 completely assembled organizer with full-extension slide, adjustable shelves, and a variety of hooks and pegs detailed below

434-BF-3SS – (8) 434-S3, (4) 434-D3, (8) 434-Peg3 1 434-Multi-5

434-BF-6SS – (3) 434-S3, (8) 434-S6, (4) 434-D6, (8) 434-Peg6

434-MB-KIT: Message Board, Eraser, Markers, and Marker Holder.

448 SERIES

PULLOUT SHELVING SYSTEM

- Adjustable shelves with chrome rails
- Brackets provide 5 inches of adjustability
- Feature our patented "tri-slides" which minimize any side-to-side motion (US Patent No. 8,388,076)
- Includes adjustable rub bushings
- Constructed from maple with a UV clear coat finish
- Door mounting is easy with our patented door mount brackets

See page 110 for base version



448-WC-8C

TRI-SLIDE
US PATENT NO: 7,306,301

ADJUSTABLE DOOR MOUNT BRACKET
US PATENT NO: 7,204,569

**MICRO-ADJUSTMENT SCREW FOR
PRECISE DOOR ALIGNMENT**

Installation is easy with the 448 Series. From the underside of the cabinet simply screw the wood block to the bottom of the cabinet for complete stability.

PRODUCT #	DESCRIPTION	PRODUCT DIMENSIONS	FINISH	SET PER CTN	WHT PER CARTON	SUGGESTED LIST PRICE
Wall Pullout Shelving System (Individual Pack)						
448-WC-5C	Wall 9" Pullout	5" (127 mm) W x 10¾" (237 mm) D x 26¼" (667 mm) H	Wood	1	14 lb.	\$131.80
448-WC-8C	Wall 12" Pullout	8" (204 mm) W x 10¾" (237 mm) D x 26¼" (667 mm) H	Wood	1	20 lb.	\$148.90
448-HP-523C	Wood Hood Pullout	5" (127 mm) W x 10¾" (237 mm) D x 23" (584 mm) H	Wood	1	13.25 lb.	\$175.90

CONTAINS: (1) Pullout Shelving System, Chrome Rails, and Full-Extension Tri-Slides. AMB BRACKETS: US PATENT NO: 8,388,076 :: TRI-SLIDE: US PATENT NO: 7,306,301

**Top Rails add
1¼" (32 mm)**

444 SERIES WALL PULLOUT ORGANIZER

- Designed for full-height Base 12" cabinets
- Door mounting is easy with our patented door mount brackets
- Brackets provide 5 inches of adjustability
- Includes adjustable rub bushings
- Constructed from maple with a UV clear coat finish
- Features a magnetic grade stainless steel panel and an array of accessory hooks
- Additional accessory hooks can be purchased separately (see page 104)

See page 109 for base version

MAGNETIC GRADE
STAINLESS STEEL PANEL

TRI-SLIDE
US PATENT NO: 7,306,301

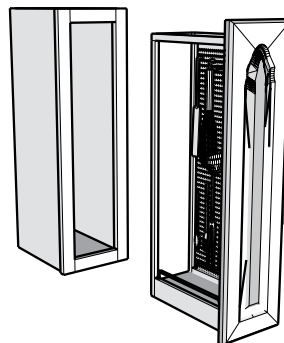

THIS PRODUCT IS INSTALLED
IN A TYPICAL 9" WALL CABINET
WITH A 5-1/2" TO 6" OPENING

WALL
ACCESSORIES

PRODUCT #	DESCRIPTION	PRODUCT DIMENSIONS	FINISH	SET PER CTN	WHT PER CARTON	SUGGESTED LIST PRICE
Wall Pullout Organizer (Individual Pack)						
444-WC-5SS	Wall Cabinet w/Stainless Steel Panel	5" (127 mm) W x 10¾" (273 mm) D x 26¼" (667 mm) H	Wood	1	12 lb.	\$208.10

CONTAINS: 444-WC-5SS: One completely assembled organizer with full-extension slides, chrome rails, rub bushings, and a variety pegs and hooks.
434-MB-KIT: Message Board, Eraser, Markers, and Marker Holder. AMB BRACKETS: US PATENT NO: 8,047,621 :: TRI-SLIDE: US PATENT NO: 7,306,301

3000 SERIES

WINE AND STEMWARE RACKS

- Heavy gauge wire construction
- Hidden mounting
- Easy to install
- Available in chrome, satin nickel, brass and oil rubbed bronze
- 11" Quad holds up to 12 glasses



3150-11SN

PRODUCT #	DESCRIPTION	PRODUCT DIMENSIONS	FINISH	SET PER CTN	WHT PER CARTON	SUGGESTED LIST PRICE
Chrome Collection (Individual Pack)						
3150-11CR	11" Stemware Holder	4¼" (108 mm) W x 11" (280 mm) D x 1½"(38 mm) H	Chrome	1	.8 lb.	\$8.25
3150-16CR	16" Stemware Holder	4¼" (108 mm) W x 16" (407 mm) D x 1½"(38 mm) H	Chrome	1	1.2 lb.	\$9.70
3150-18CR	18" Stemware Holder	4¼" (108 mm) W x 18" (457 mm) D x 1½"(38 mm) H	Chrome	1	2 lb.	\$10.90
3250CR	Double Bottle Rack	4¼" (108 mm) W x 9" (229 mm) H x ⅝"(16 mm)Thick	Chrome	1	1.5 lb.	\$13.90
3450-11CR	11" Quad Stemware Holder	17" (432 mm) W x 11" (280 mm) D x 1½"(38 mm) H	Chrome	1	3.3 lb.	\$30.15
Satin Nickel Collection (Individual Pack)						
3150-11SN	11" Stemware Holder	4¼" (108 mm) W x 11" (280 mm) D x 1½"(38 mm) H	Satin Nickel	1	.8 lb.	\$9.45
3150-16SN	16" Stemware Holder	4¼" (108 mm) W x 16" (407 mm) D x 1½"(38 mm) H	Satin Nickel	1	1.2 lb.	\$11.15
3150-18SN	18" Stemware Holder	4¼" (108 mm) W x 18" (457 mm) D x 1½"(38 mm) H	Satin Nickel	1	2 lb.	\$12.45
3250SN	Double Bottle Rack	4¼" (108 mm) W x 9" (229 mm) H x ⅝"(16 mm)Thick	Satin Nickel	1	1.5 lb.	\$15.65
3450-11SN	11" Quad Stemware Holder	17" (432 mm) W x 11" (280 mm) D x 1½"(38 mm) H	Satin Nickel	1	3.3 lb.	\$35.25
Brass Collection (Individual Pack)						
3150-11BR	11" Stemware Holder	4¼" (108 mm) W x 11" (280 mm) D x 1½"(38 mm) H	Brass	1	.8 lb.	\$9.70
3150-16BR	16" Stemware Holder	4¼" (108 mm) W x 16" (407 mm) D x 1½"(38 mm) H	Brass	1	1.2 lb.	\$11.75
3150-18BR	18" Stemware Holder	4¼" (108 mm) W x 18" (457 mm) D x 1½"(38 mm) H	Brass	1	2 lb.	\$13.05
3250BR	Double Bottle Rack	4¼" (108 mm) W x 9" (229 mm) H x ⅝"(16 mm)Thick	Brass	1	1.5 lb.	\$16.40
3450-11BR	11" Quad Stemware Holder	17" (432 mm) W x 11" (280 mm) D x 1½"(38 mm) H	Brass	1	3.3 lb.	\$36.85
Oil Rubbed Bronze Collection (Individual Pack)						
3150-11ORB	11" Stemware Holder	4¼" (108 mm) W x 11" (280 mm) D x 1½"(38 mm) H	Oil Rubbed Bronze	1	.8 lb.	\$11.00
3150-16ORB	16" Stemware Holder	4¼" (108 mm) W x 16" (407 mm) D x 1½"(38 mm) H	Oil Rubbed Bronze	1	1.2 lb.	\$12.45
3150-18ORB	18" Stemware Holder	4¼" (108 mm) W x 18" (457 mm) D x 1½"(38 mm) H	Oil Rubbed Bronze	1	2 lb.	\$13.90
3250ORB	Double Bottle Rack	4¼" (108 mm) W x 9" (229 mm) H x ⅝"(16 mm)Thick	Oil Rubbed Bronze	1	1.5 lb.	\$19.60
3450-11ORB	11" Quad Stemware Holder	17" (432 mm) W x 11" (280 mm) D x 1½"(38 mm) H	Oil Rubbed Bronze	1	4 lb.	\$39.45

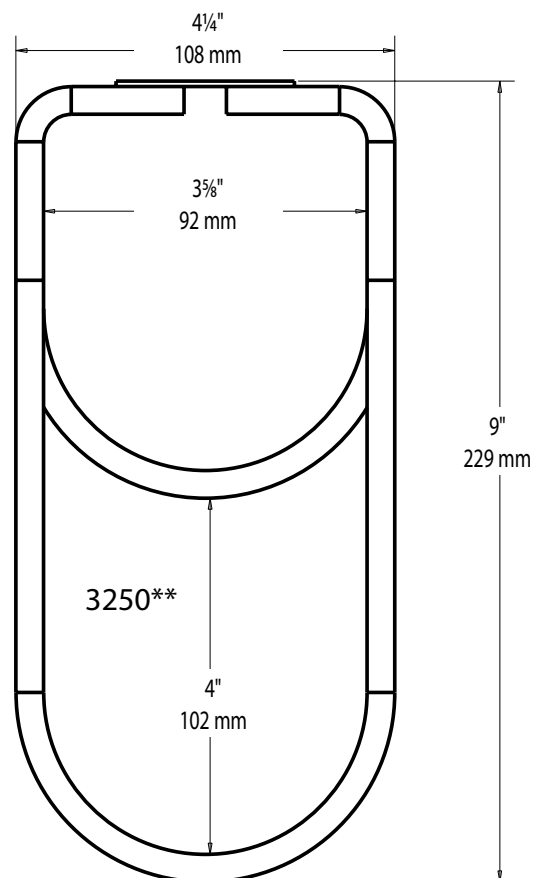
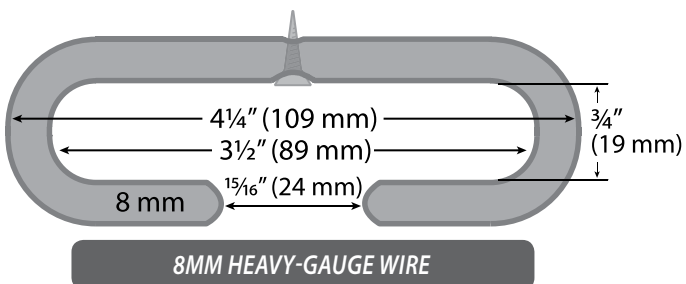
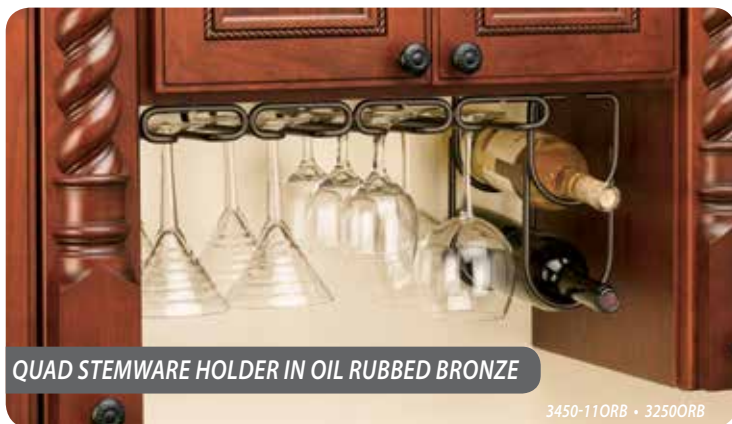

5PD SERIES PREMIERE PULL-DOWN SHELVING SYSTEM

- Available for Wall 24" and 36" cabinets
- Brings items down 11-1/2" while pulling out 16-3/4" from the cabinet
- Features a unique gas assisted lifting/lowering mechanism
- Chrome-plated two-tier pull-down shelf
- Locks into the down position for hands free accessibility
- Includes both side and bottom mount brackets
- Pre-assembled baskets for easy installation



BOTTOM MOUNTED



SIDE MOUNTED



LOCKS INTO LOWERED POSITION

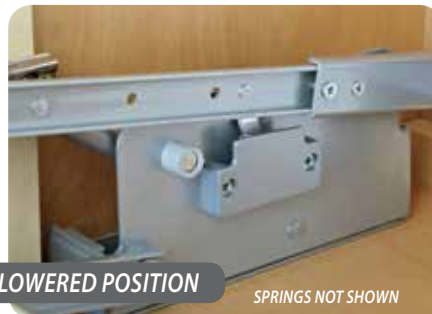

SPRINGS NOT SHOWN

PRODUCT #	DESCRIPTION	PRODUCT DIMENSIONS	FINISH	SET PER CTN	WHT PER CARTON	SUGGESTED LIST PRICE
Pull-Down Shelving System (Individual Pack)						
5PD-24CRN	Pull-Down Shelving System	See Drawings on Opposite Page	Metal/Chrome	1	23 lb.	\$466.20
5PD-36CRN	Pull-Down Shelving System	See Drawings on Opposite Page	Metal/Chrome	1	27 lb.	\$490.70

CONTAINS: (1) shelving unit, mounting brackets, screws and instructions
WEIGHT CAPACITY: 5PD-24CRN: 17 lb., 5PD-36CRN: 26 lb.

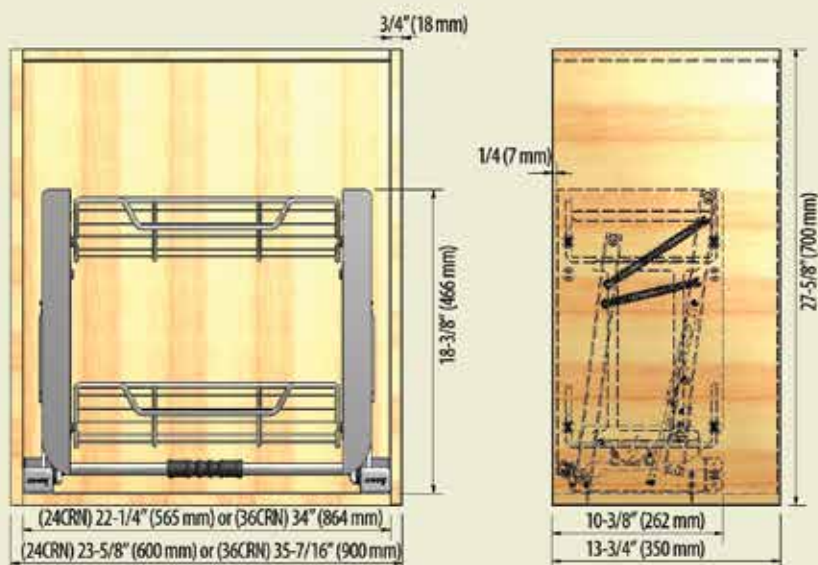
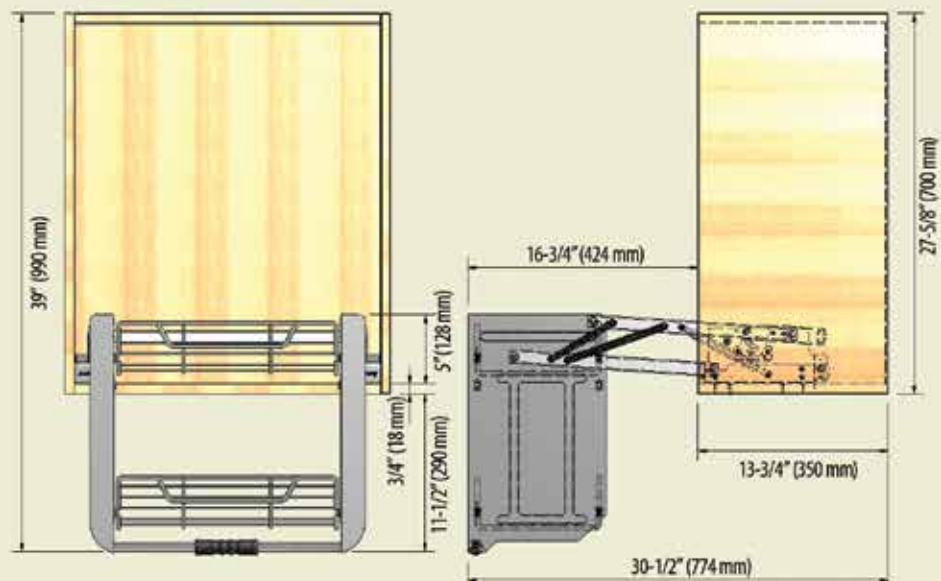

Minimum Opening

SPD-24CRN	21" (534 mm)
SPD-36CRN	33" (838 mm)

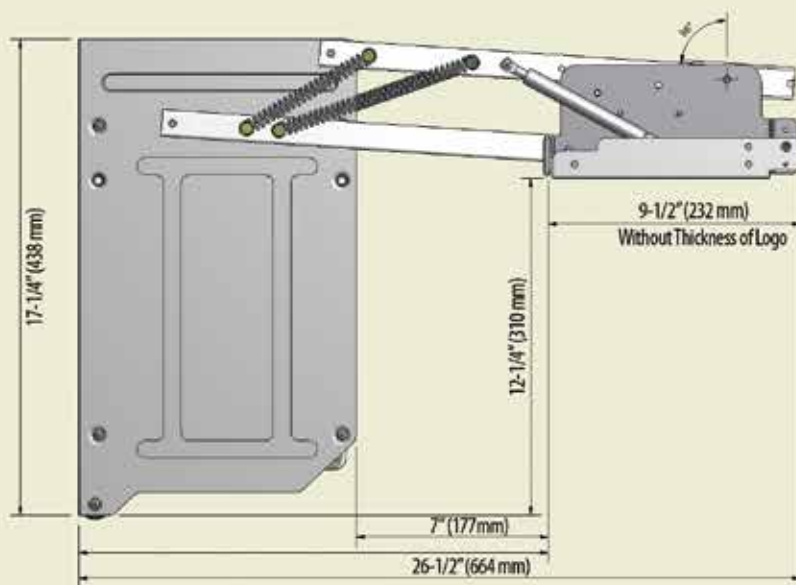
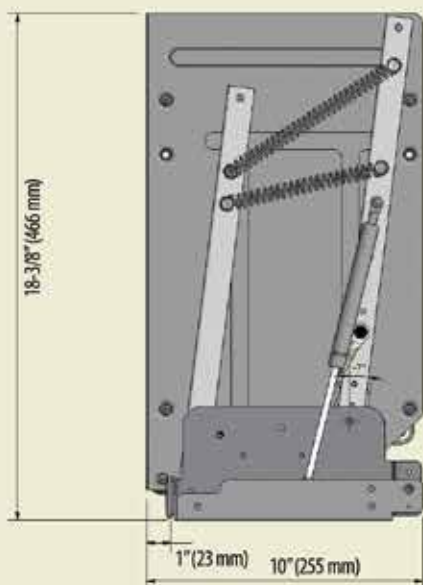

5UPD SERIES

UNIVERSAL PULL-DOWN

- Available for Wall 24"
- Features a unique gas assisted lifting/lowering mechanism
- Locks into the down position for hands free accessibility
- Includes drop-in dividers and scalloped inserts
- Features acrylic storage bins
- Includes both side and bottom mount brackets



For video visit:
rev-a-shelf.com/videos



UNIVERSAL
pull-down

MEDICAL SUPPLIES



BEVERAGES



SPICES



PET

PRODUCT #	DESCRIPTION	PRODUCT DIMENSIONS	FINISH	SET PER CTN	WHT PER CARTON	SUGGESTED LIST PRICE
Universal Pull-Down Shelving System (Individual Pack)						
5UPD-24CRN	Universal Pull-Down	22¼" (566 mm) W x 10½" (267 mm) D x 21½" (547 mm) H	Metal/Chrome	1	42 lb.	\$874.95

CONTAINS: (1) Universal Pull-Down with removable acrylic bins, dividers, scallops, and drawer liners. Pre-printed and blank labels also included.
WEIGHT CAPACITY: 13 lb.



SCALLOPED INSERTS FOR MEDICAL AND SPICE BOTTLE STORAGE



REMOVABLE ACRYLIC BINS



PRE-PRINTED AND CUSTOMIZABLE LABELS



SIDE MOUNTED



BOTTOM MOUNTED

FOR DETAILED SPECS SEE NEXT PAGE

UNIVERSAL pulldown

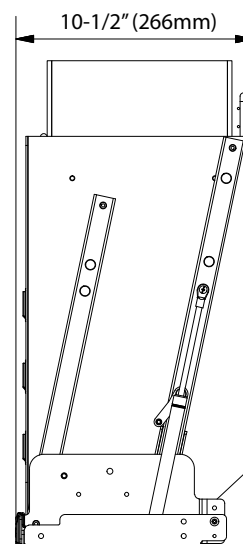
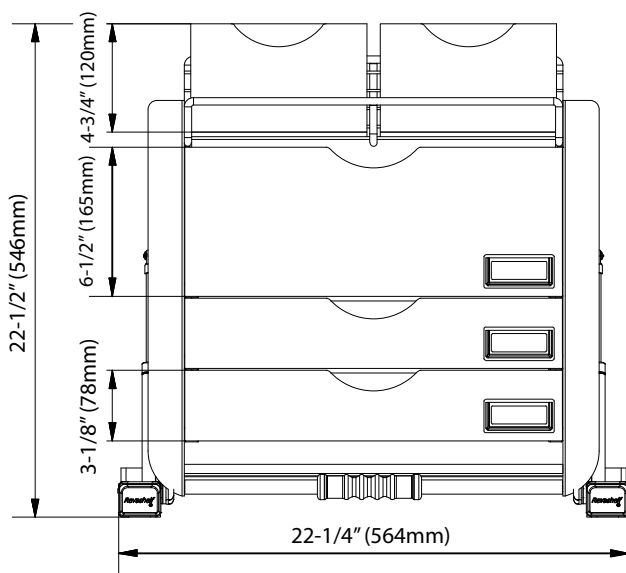
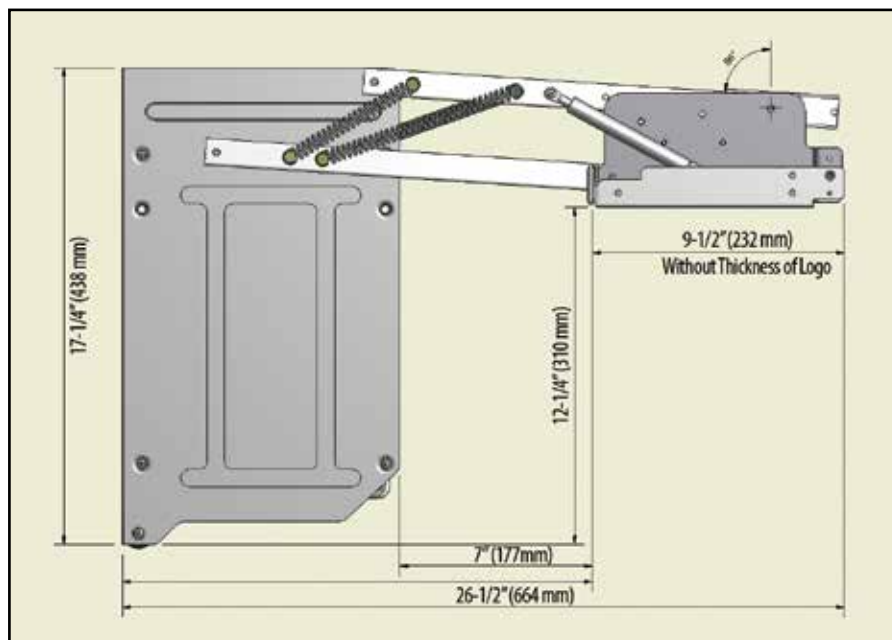

Minimum Opening

SUPD-24CRN	21" (534 mm)
------------	--------------

